



PRODUCT CATALOGUE 2025

Surface heating and cooling systems





Surface heating



Smart Home



Sustainable raw materials



Thin layer

Relying on sustainable raw materials, conserving resources, and saving on carbon dioxide emissions – these are increasingly crucial factors.

Efficiently use renewable energies without sacrificing comfort, and undertake renovations as well as new construction projects in a durable and ecological manner – that is the future. The new Blanke surface heating and cooling systems make it possible.

Our new and sustainable product highlights for 2024 can be found from page 22.

Were you aware of this? Even an older house will become more energy-efficient – without an extensive energy-oriented renovation – with a surface heating system. You can save up to 20% of your primary energy consumption simply by installing underfloor heating.





Blanke Systems – systems that impress.



Thin layer

At Blanke you will only find thin-layer surface heating systems with an installation height of between 12 mm and 59 mm which are both ideal for renovation projects and suitable for new buildings. Due to the thin layer design and low mass per unit area they can be installed anywhere.



Choice of systems, variety

Nothing is impossible! With our system diversity you will find a solution for every challenge on the construction site. Water-based system or electric, thin-layer design and for walls and floors. Innovation in the field of surface heating is our driving force.



Everything from a single source

It is important for us to consider the entire floor construction, and not just the corresponding surface heating and cooling system. This means we can supply you with surface heating components for proven heating systems. Alongside levelling compounds, installation elements and pipes, in this catalogue you will find control system components and smart home solutions.



Sustainable

To build more sustainably in the long term, even small changes make a big difference. If you want to save on screed, take a look at our dry installation systems. Those who place value on systems made from renewable, ecological raw materials should take a look at our PERMATOP NATURE or PERMATOP WOOD ranges.



Fast

Depending on the system, you can save up to 4 - 6 weeks installation time. Blanke systems are either installed without screed and any drying time at all or you can use BLANKE PERMATOP combined with ceramic coverings, which allows you to walk on the surface shortly after the installation. With the BLANKE PERMATOP SF, for example, the BLANKE FILLER can be walked on after just 3 hours and the floor-laying work can be carried out straight away. Further information can be found under the respective systems.



Eligible for a subsidy

With the German BEG subsidy programmes, you can apply for financial support for your building project. The hydraulic calibration of the heating system is one of the requirements for a subsidy. Our Blanke Smart Home solutions can be used to help here as they harmonise perfectly with our systems. We will be glad to explain the application process before you begin with your project.



Made for craftsmen

You have never installed surface heating before? That doesn't matter! Our systems are made for installers and can be fitted in a few simple steps. With the dry installation systems, you can ask for an installation plan and a quantity calculation.



Warranty

With all the BLANKE system products, in addition to the statutory warranty you receive a further warranty which guarantees that the screed installation is free of cupping and that the ceramic floor covering will not crack when using our system products.



tested systems





Expertise and quality – an impressive service

Experience ideally coordinated surface heating and cooling systems for every construction site situation – in combination with our expert advice an unbeatable solution!



On-site consultation/construction site briefing

If you are installing one of our systems for the first time, you can request a construction site briefing from our regional manager. We assist you on site during the first installation and show you what to look out for. So nothing can go wrong!



Technical consulting/planning

Our experts work on the premises. Our team will be happy to help you with the technical side of our systems - both when choosing them and then later during the installation.



Choosing a system

Comprehensive recommendations and individual consulting from our team of experts - in person or online



Digital consulting tools

The Blanke Blue Base quickly and easily provides all the details about our products and systems. Here you will find technical data sheets, installation instructions and installation videos. The Blanke Blue Base is now even better! Designing the shower area, choosing the right surface heating or finding the right profile can be done in under 2 minutes using the integrated product advisors.



Training courses

You can find all training courses on our Blanke Blue Base in the menu under Training.



BLANKE PERMATOP BF+ 34



22 BLANKE PERMATOP ECO



24 BLANKE PERMATOP NATURE

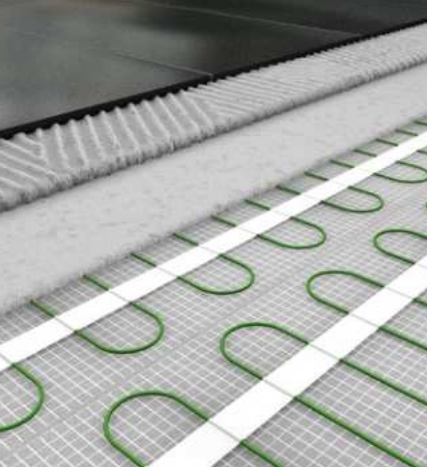

60 BLANKE ELOTOP*

BLANKE PERMATOP WALL 26

54 BLANKE ELOTOP CARBON

01 UNDERFLOOR HEATING AND COOLING SYSTEMS, WATER RUN

BLANKE PERMATOP - MATRIX	12
BLANKE PERMATOP 1000	
Underfloor heating and cooling systems	16
BLANKE PERMATOP 3000	
Underfloor heating and cooling systems	18
BLANKE PERMATOP WOOD	
Underfloor heating and cooling systems	20
BLANKE PERMATOP ECO	
Underfloor heating and cooling systems	22
BLANKE PERMATOP NATURE	
Underfloor heating and cooling systems	24
BLANKE PERMATOP WALL	
Underfloor heating and cooling systems	26
BLANKE PERMATOP SF	
Underfloor heating and cooling systems	30
BLANKE PERMATOP SF 14	
Underfloor heating and cooling systems	32
BLANKE PERMATOP BF, BF+, BFC	
Underfloor heating and cooling systems	34
BLANKE PERMATOP BF, BF+, BFC accessories	36

02 HYDRAULICS

BLANKE HEATING CIRCUIT MANIFOLD VARIO and accessories	40
---	----

03 SMART HOME

BLANKE SMART HOME LIFE	46
BLANKE CONTROL 230	48

04 SURFACE HEATING SYSTEMS ELECTRICAL

BLANKE ELOTOP - MATRIX	52
BLANKE ELOTOP CARBON Wall and underfloor heating	54
BLANKE HASTA	57
BLANKE HOOK	57
BLANKE ELOTOP 1000 Electric underfloor heating	58
BLANKE ELOTOP+ Electric floor temperature control	60

05 SUPPLEMENTAL PRODUCTS

BLANKE PERMAT	64
BLANKE GROUND	66
BLANKE GLUEMAX	66
BLANKE SF FILLER	66
BLANKE FILLOTHERM	66
BLANKE GLASS FIBRE MESH P 100	67
BLANKE GLASS FIBRE MESH 15 SK	67
BLANKE Toos for surface heating systems	68
Glossary	70

01

02

03

UNDERFLOOR HEATING AND COOLING SYSTEMS, WATER RUN

04

05

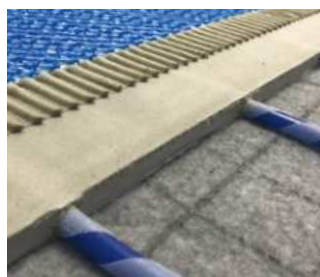

30 BLANKE PERMATOP SF



34 BLANKE PERMATOP BF+



18 BLANKE PERMATOP 3000

BLANKE PERMATOP – MATRIX DRY INSTALLATION SYSTEMS

System

BLANKE PERMATOP 1000



Components

Straight panel EPS	100 × 50 cm
Return panel EPS	50 × 25 cm
Adjustment panel EPS	100 × 50 cm
Edge insulation strip	
Composite metal piping	16 × 2 mm
BLANKE GLUEMAX	
BLANKE PERMAT	Material thickness 3.3 mm

Height

35 mm incl. BLANKE PERMAT

Substrate & Installation

even and ready for installation; see installation instructions bonded to the substrate floor

Weight per unit area

approx. 11 kg/m² (IG 12.5 cm) approx. 10 kg/m² (IG 25 cm)

Advantages

fast reaction, thin, heating & cooling, light, low humidity (as screed-free), low installation height, short curing time

BLANKE PERMATOP 3000

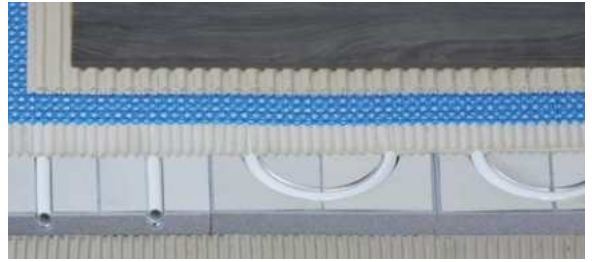

Straight panel EPS w. i. g. p.*	100 × 50 cm
Return panel EPS w. i. g. p.*	50 × 25 cm
Adjustment panel EPS w. i. g. p.*	100 × 50 cm
Edge insulation strip	
Composite metal piping	16 × 2 mm
BLANKE GLUEMAX	
BLANKE PERMAT	Material thickness 3.3 mm

31 mm incl. BLANKE PERMAT

even and ready for installation; see installation instructions bonded to the substrate floor

approx. 11 kg/m² (IG 12.5 cm) approx. 10 kg/m² (IG 25 cm)

fast reaction, thin, heating & cooling, light, low humidity (as screed-free), low installation height, short curing time

System

BLANKE PERMATOP NATURE



Components

Straight panel Stroh	100 × 50 cm
Return panel Stroh	25 × 50 cm
Adjustment panel Stroh	100 × 50 cm
Edge insulation strip Wellpappe	
Composite metal piping	16 × 2 mm
BLANKE GLUEMAX	
BLANKE PERMAT	Material thickness 3.3 mm

Height

35 mm incl. BLANKE PERMAT

Substrate & Installation

even and ready for installation; see installation instructions bonded to the substrate floor, fast-setting flexible adhesive use

Weight per unit area

approx. 18 kg/m² (IG 12.5 cm) approx. 17 kg/m² (IG 25 cm)

Advantages

fast reaction, thin, heating & cooling, light, low humidity (as screed-free), low installation height, short curing time

BLANKE PERMATOP WALL



Straight panel EPS	100 × 50 cm
Return panel EPS	50 × 25 cm
Adjustment panel EPS	100 × 50 cm
Edge insulation strip	
BLANKE PIPE 16	16 × 2 mm
BLANKE GLUEMAX	
BLANKE PERMAT	Material thickness 3.3 mm

35 mm incl. BLANKE PERMAT

even and ready for installation; see installation instructions firmly bonded to the existing substrate, additionally screwed in place with plate dowels above the BLANKE PERMAT

-

fast reacting, thin layered, heating & cooling, low installation height, short curing time

* EPS with embedded graphite particles

BLANKE PERMATOP WOOD



Straight panel wood fibres	100 × 50 cm
Return panel wood fibres	50 × 25 cm
Adjustment panel wood fibres	100 × 50 cm
Edge insulation strip	
Composite metal piping	16 × 2 mm
BLANKE GLUEMAX	
BLANKE PERMAT	Material thickness 3.3 mm

35 mm incl. BLANKE PERMAT

even and ready for installation; see installation instructions, bonded to the substrate floor, fast-setting flexible adhesive use

approx. 15 kg/m² (IG 12.5 cm), approx. 13 kg/m² (IG 25 cm)

fast reaction, thin, heating & cooling, ecological, light, low humidity (as screed-free), low installation height, short curing time

BLANKE PERMATOP ECO

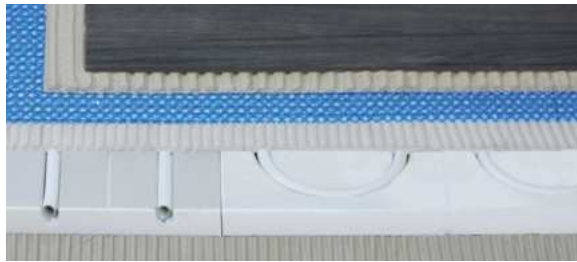

Straight panel EPS	100 × 50 cm
Return panel EPS (6 pcs.)	100 × 50 cm
Adjustment panel EPS	100 × 50 cm
Edge insulation strip	
Composite metal piping	16 × 2 mm
BLANKE GLUEMAX	
BLANKE PERMAT	Material thickness 3.3 mm

35 mm incl. BLANKE PERMAT

even and ready for installation; see installation instructions bonded to the substrate floor

approx. 10 kg/m² (IG 16.6 cm)

fast reaction, thin, heating & cooling, light, low humidity (as screed-free), low installation height, short curing time

BLANKE PERMATOP – MATRIX SCREED SYSTEMS

System

BLANKE PERMATOP SF



Components

BLANKE SF BASE	1.05 × 20 m
BLANKE RDS 5/50	5 × 50 mm/25 m Ro
BLANKE SF KLETT-TEC	10 × 1.3 mm
BLANKE SF FILLER	25 kg/m ² when pipe covered by 1 mm
BLANKE PERMAT	Material thickness 3,3 mm

Height

12 mm top edge filler / 17 mm incl. BLANKE PERMAT

Substrate & Installation

existing load bearing underground with existing thermal insulation, even and ready for installation; see installation instructions self adhesive (Primer required)

Weight per unit area

approx. 25 kg with 1 mm coverage

Advantages

thin and fast reacting, heating & cooling, self-levelling easy levelling thanks to BLANKE SF FILLER, fast installation with short waiting time, no screed removal, dirt and noise free, 5 layer PE-RT heating pipe

System

BLANKE PERMATOP SF 14



Components

BLANKE SF BASE	1.05 × 20 m
BLANKE RDS 5/50	5 × 50 mm/25 m Ro
BLANKE SF KLETT-TEC	14 × 2.0 mm
SF FILLOTHERM	approx. 30 kg/m ² when covered by 1 mm
BLANKE PERMAT	Material thickness 3,3 mm

Height

16 mm top edge Fillotherm / 21 mm incl. BLANKE PERMAT

Substrate & Installation

existing load bearing underground with existing thermal insulation, even and ready for installation; see installation instructions

Weight per unit area

approx. 30 kg with 1 mm coverage

Advantages

thin and fast reacting, heating & cooling, self-levelling thanks to BLANKE FILLOTHERM, fast installation with short waiting time, no screed removal, dirt and noise free, 5 layer PE-RT heating pipe

BLANKE PERMATOP BF



BLANKE BF BASE

Height 20 mm

BLANKE RDS 10/120

10 × 120 mm/50 m Ro

BLANKE PIPE 14

14 × 2 mm gray

BLANKE PIPE 16

16 × 2 mm blue

standard screed

BLANKE PERMAT*

Material thickness 3.3 mm

from 28 mm (screed without BLANKE PERMAT, mat height and screed of min. 8 mm height, when installing tiles)

even and ready for installation: application for new and existing buildings as well as refurbishment; see installation instructions loose installation

approx. 40 kg with 8 mm coverage

fast reacting, thin, heating & cooling, fast curing, 5 layer PE-RT heating pipe, cupping-free screed, no expansion joints in screed, no adjustment of heating circles to the joint arrangement of tiles

BLANKE PERMATOP BF+



BLANKE BF+ BASE	Height 31 mm
BLANKE RDS 10/120 SK	10 × 120 mm/50 m Ro
BLANKE RDS 10/120	10 × 120 mm/50 m Ro
BLANKE PIPE 14	14 × 2 mm gray
BLANKE PIPE 16	16 × 2 mm blue
BLANKE FILLOTHERM or standard screed	40 kg/m ² when covered by 8 mm
BLANKE PERMAT*	Material thickness 3.3 mm

from 39 mm (screed without BLANKE PERMAT, mat height and screed of min. 8mm height, when installing tiles)

even and ready for installation: application for new and existing buildings as well as refurbishment; see installation instructions loose installation

approx. 40 kg with 8 mm coverage

fast-reacting, thin layer construction height, heating and cooling, short drying times, easy levelling with BLANKE FILLOTHERM, 5-layer PE-RT piping with EVOH barrier layer, cupping-free screed, no expansion joints in the screed, no need to distribute the heating circuits according to the joint pattern of the floor surface covering, incl. thermal insulation

BLANKE PERMATOP BFC



BLANKE BFC BASE	Height 51 mm
BLANKE RDS 10/120 SK	10 × 120 mm/50m Ro
BLANKE RDS 10/120	10 × 120 mm/50m Ro
BLANKE PIPE 14	14 × 2 mm gray
BLANKE PIPE 16	16 × 2 mm blue
BLANKE FILLOTHERM or standard screed	40 kg/m ² when covered by 8 mm
BLANKE PERMAT*	Material thickness 3.3 mm

from 59 mm (screed without BLANKE PERMAT, mat height and screed of min. 8mm height, when installing tiles)

even and ready for installation: application for new and existing buildings as well as refurbishment; see installation instructions loose installation

approx. 40 kg with 8 mm coverage

fast reacting, thin, heating & cooling, no waiting time, easy levelling thanks to BLANKE FILLOTHERM, 5-layer PE-RT heating pipe, cupping-free screed, no expansion joints in screed, no adjustment of heating circles to the joint arrangement of tiles, with heat and impact sound insulation

> All installation height without top covering

* BLANKE PERMAT only required when tiles or stones are installed



Important note:

All PERMATOP 1000 components are now available individually. Please note that no planning service is provided in this case.

BLANKE PERMATOP 1000

BLANKE PERMATOP 1000 is a dry lining surface heating and cooling system with an installation height of 35 mm. Aluminium heat diffusion plates are bonded ex works to the EPS-based installation panels, allowing the heat to be distributed quickly and evenly across the floor. The metal composite piping can simply be inserted into the prefabricated Omega loop. The system also offers high compressive stability thanks to the BLANKE PERMAT decoupling mat, which is bonded using BLANKE GLUEMAX. This combination allows for a thin installation and fast heat distribution without the need for conventional screed. The low weight per unit area of just under 11 kg/m² allows the use of a water-based surface area heating system, in particular for renovations, in wooden buildings or on storeys with wood beam ceilings.

BLANKE PERMATOP 1000 SET / INSTALLATION HEIGHT 35 mm INCL. BLANKE PERMAT (FOR TRAFFIC LOADS UP TO 5.0 kN/m²)

BLANKE PERMATOP 1000 1000/12.5

Installation gap: 12.5 cm; Thermal conductivity group: WLS 035

PU: 1 set

Art. no.

651-900-1000-12

BLANKE PERMATOP 1000 1000/25

Installation gap: 25.0 cm; Thermal conductivity group: WLS 035

PU: 1 set

Art. no.

651-900-1000-25

BLANKE PERMATOP 1000 COMPONENTS

Expert tip:

BLANKE PERMATOP 1000 is particularly suitable for areas subject to live loads up to 5.0 kN/m².

The 1000, 3000, WOOD, WALL and NATURE systems can be installed with an installation gap of 25 cm or 12.5 cm.

BLANKE PERMATOP 1000 STRAIGHT PANEL

10 pieces/PU

Panel dimension: 100 × 50 cm (0.50 m²)
Installation gap: 12.5 cm

Thermal conductivity group: WLS 035

PU: 10 pieces

Art. no.

651-900-1000-11

BLANKE PERMATOP 1000 STRAIGHT PANEL

10 pieces/PU

Panel dimension: 100 × 50 cm (0.50 m²)
Installation gap: 25.0 cm

Thermal conductivity group: WLS 035

PU: 10 pieces

Art. no.

651-900-1000-10

BLANKE PERMATOP 1000 RETURN PANEL

10 pieces/carton

Panel dimension: 25 × 50 cm (0.125 m²)
Installation gap: 12.5 cm

Thermal conductivity group: WLS 035

PU: 1 carton

Art. no.

651-900-1000-08

BLANKE PERMATOP 1000 RETURN PANEL

10 pieces/carton

Panel dimension: 25 × 50 cm (0.125 m²)
Installation gap: 25.0 cm

Thermal conductivity group: WLS 035

PU: 1 carton

Art. no.

651-900-1000-09

BLANKE PERMATOP 1000 EPS-INSULATION PANEL

16 pieces/PU

Panel dimension: 100 × 50 × 3 cm (0.50 m³)

PU: 16 pieces

Art. no.

214-900-03

BLANKE PERMAT

30 mats/carton

Dimensions: 97 × 62 cm

PU: 1 carton

Art. no.

1 carton = 18 m² 527-904

1 pallet (11 × cartons) = 198 m² 527-904

1 pallet (334 × individual panels) = 200 m² 527-904-PAL

BLANKE PERMATOP 1000/3000 EDGE INSULATION STRIP

Length: 50 m

PU: 1 roll

w=cm

Art. no.

10.0

214-900-02

BLANKE PERMATOP 1000/3000 COMPOSITE METAL PIPING

Dimensions: 16 × 2 mm

PU: 1 roll

Length=m

Art. no.

300.0

651-900-1000-07

500.0

651-900-1000-04

SYSTEM COMPONENTS RECOMMENDATION: FLOOR CONSTRUCTION



- 1 BLANKE PERMATOP 1000
Grooved panel
- 2 BLANKE PERMATOP 1000
Return panel
- 3 BLANKE PERMATOP 1000
Composite metal piping
- 4 BLANKE RDS
- 5 BLANKE GLUEMAX
- 6 BLANKE PERMAT

SYSTEM COMPONENTS RECOMMENDATION: HYDRAULICS



- 7 BLANKE HEATING CIRCUIT
MANIFOLD VARIO
- 8 BLANKE MANIFOLD SHUT-OFF,
SUPPLY (RED)
- 9 BLANKE MANIFOLD SHUT-OFF,
RETURN FLOW (BLUE)
- 10 BLANKE MANIFOLD CABINET
- 11 BLANKE COMPRESSION FITTING

Important note:

All hydraulic products can be found under the respective product accessories and from page 38.

SYSTEM COMPONENTS RECOMMENDATION: CONTROL SYSTEM



- 12 BLANKE ROOM-CONTROL
DEVICE SMART HOME LIFE
- 13 BLANKE BASE UNIT
SMART HOME LIFE
- 14 BLANKE ACTUATOR
NC 230 V

Important note:

All the control system products can be found under SMART HOME from page 44.

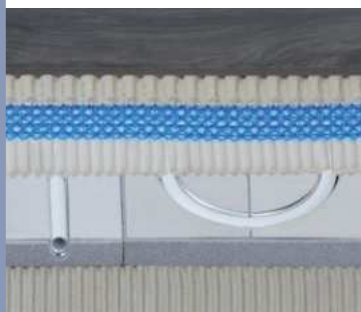

BLANKE PERMATOP 3000

BLANKE PERMATOP 3000 is a water-based surface heating and cooling system with a dry construction. It is based on an EPS installation panel with embedded graphite particles, which results in a better insulation value. With an installation height of 31 mm and a weight of approx. 10 kg/m² it is ideal for renovations. The factory-bonded aluminium heat diffusion plate distributes the heat quickly and evenly. The system's metal composite piping is inserted into the prefabricated Omega loop. Installation gaps of 12.5 cm and 25.0 cm can be used. Thanks to the BLANKE PERMAT decoupling mat, the system offers high compressive stability. At the same time there is no need for screed, reducing the construction time by up to 4 weeks.

Important notes:

All PERMATOP 3000 components are now available individually. Please note that no planning service is provided in this case.

BLANKE PERMATOP 3000 SET / INSTALLATION HEIGHT 31 mm INCL. BLANKE PERMAT (FOR TRAFFIC LOADS UP TO 2.0 kN/m²)

BLANKE PERMATOP 3000 3000/12.5

Installation gap: 12.5 cm;
Thermal conductivity group: WLS 032 PU: 1 set

Art. no.

651-900-3000-12

BLANKE PERMATOP 3000 3000/25

Installation gap: 25.0 cm;
Thermal conductivity group: WLS 032 PU: 1 set

Art. no.

651-900-3000-25

BLANKE PERMATOP 3000 COMPONENTS

Expert tip:

BLANKE PERMATOP 3000 is the perfect solution for low installation heights.

BLANKE PERMATOP 3000 STRAIGHT PANEL

STRAIGHT PANEL

10 pieces/PU
Panel dimension: 100 × 50 cm (0.50 m²)
Installation gap: 12.5 cm
Thermal conductivity group: WLS 032 PU: 10 pieces

Art. no.

651-900-3000-02

BLANKE PERMATOP 3000 STRAIGHT PANEL

STRAIGHT PANEL

10 pieces/PU
Panel dimension: 100 × 50 cm (0.50 m²)
Installation gap: 25.0 cm
Thermal conductivity group: WLS 032 PU: 10 pieces

Art. no.

651-900-3000-06

BLANKE PERMATOP 3000 RETURN PANEL

RETURN PANEL

10 pieces/carton
Panel dimension: 25 × 50 cm (0.125 m²)
Installation gap: 12.5 cm
Thermal conductivity group: WLS 032 PU: 1 carton

Art. no.

651-900-3000-08

BLANKE PERMATOP 3000 RETURN PANEL

RETURN PANEL

10 pieces/carton
Panel dimension: 25 × 50 cm (0.125 m²)
Installation gap: 25.0 cm
Thermal conductivity group: WLS 032 PU: 1 carton

Art. no.

651-900-3000-09

BLANKE PERMATOP 3000 CONSTRUCTION BOARD

CONSTRUCTION BOARD

10 pieces/PU
Panel dimension: 100 × 50 cm (0.50 m²) PU: 10 pieces

Art. no.

651-900-3000-03

BLANKE PERMAT

30 mats/carton

Dimensions: 97 × 62 cm PU: 1 carton

Art. no.

1 carton = 18 m² 527-904

1 pallet (11 × cartons) = 198 m² 527-904

1 pallet (334 × individual panels) = 200 m² 527-904-PAL

BLANKE PERMATOP 1000/3000 EDGE INSULATION STRIP

EDGE INSULATION STRIP

Length: 50 m PU: 1 roll

w=cm

10.0

Art. no.

214-900-02

BLANKE PERMATOP 1000/3000 COMPOSITE METAL PIPING

COMPOSITE METAL PIPING

Dimensions: 16 × 2 mm PU: 1 roll

Length=m

300.0

500.0

Art. no.

651-900-1000-07

651-900-1000-04

SYSTEM COMPONENTS RECOMMENDATION: FLOOR CONSTRUCTION

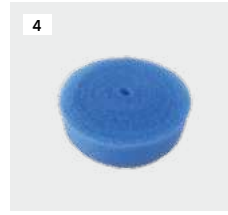
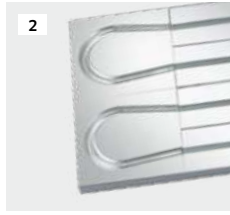

- 1 BLANKE PERMATOP 3000 Grooved panel
- 2 BLANKE PERMATOP 3000 Return panel
- 3 BLANKE PERMATOP 3000 Composite metal piping
- 4 BLANKE RDS
- 5 BLANKE GLUEMAX
- 6 BLANKE PERMAT

SYSTEM COMPONENTS RECOMMENDATION: HYDRAULICS



- 7 BLANKE HEATING CIRCUIT MANIFOLD VARIO
- 8 BLANKE MANIFOLD SHUT-OFF, SUPPLY (RED)
- 9 BLANKE MANIFOLD SHUT-OFF, RETURN FLOW (BLUE)
- 10 BLANKE MANIFOLD CABINET
- 11 BLANKE COMPRESSION FITTING

Important note:

All hydraulic products can be found under the respective product accessories and from page 38.

SYSTEM COMPONENTS RECOMMENDATION: CONTROL SYSTEM



- 12 BLANKE ROOM-CONTROL DEVICE SMART HOME LIFE
- 13 BLANKE BASE UNIT SMART HOME LIFE
- 14 BLANKE ACTUATOR NC 230 V

Important note:

All the control system products can be found under SMART HOME from page 44.



BLANKE PERMATOP WOOD

BLANKE PERMATOP WOOD is an ecological surface heating and cooling system with wood insulation (WLS 055). Wood, as a renewable raw material, binds CO₂ during the growth process, making this system especially suitable for sustainable buildings and green building projects. With an installation height of 35 mm, the water-based dry construction system is suitable for both renovations and new buildings.

It is based on individual heating elements with factory-fitted aluminium heat diffusion plates and high-quality metal composite piping. The system also offers high compressive stability thanks to the BLANKE PERMAT decoupling mat, which is bonded using BLANKE GLUEMAX. This combination allows for a thin structure and fast heat distribution without the need for conventional screed. The ecological system panel features edge insulation strips made of corrugated board.

Important notes:

Suitable accessories for BLANKE PERMATOP WOOD are listed on page 28.



BLANKE PERMATOP WOOD / INSTALLATION HEIGHT 35 mm INCL. BLANKE PERMAT (SUSTAINABLE VERSION FOR TRAFFIC LOADS UP TO 2.0 kN/m²)

BLANKE PERMATOP WOOD

Installation gap: 12.5 cm;

Thermal conductivity group: WLS 050

PU: 1 set

Art. no.

651-900-4000-12

BLANKE PERMATOP WOOD

Installation gap: 25.0 cm;

Thermal conductivity group: WLS 050

PU: 1 set

Art. no.

651-900-4000-25



SYSTEM COMPONENTS RECOMMENDATION: FLOOR CONSTRUCTION

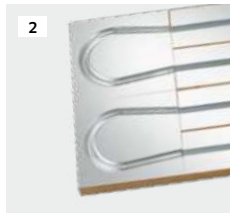
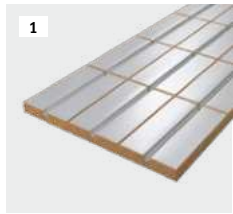

- 1 BLANKE PERMATOP WOOD Straight panel
- 2 BLANKE PERMATOP WOOD Return panel
- 3 BLANKE PERMATOP WOOD Composite metal piping
- 4 BLANKE RDS
- 5 BLANKE GLUEMAX
- 6 BLANKE PERMAT



SYSTEM COMPONENTS RECOMMENDATION: HYDRAULICS



- 7 BLANKE HEATING CIRCUIT MANIFOLD VARIO
- 8 BLANKE MANIFOLD SHUT-OFF, SUPPLY (RED)
- 9 BLANKE MANIFOLD SHUT-OFF, RETURN FLOW (BLUE)
- 10 BLANKE MANIFOLD CABINET
- 11 BLANKE COMPRESSION FITTING



Important note:

All hydraulic products can be found under the respective product accessories and from page 38.

SYSTEM COMPONENTS RECOMMENDATION: CONTROL SYSTEM



- 12 BLANKE ROOM-CONTROL DEVICE SMART HOME LIFE
- 13 BLANKE BASE UNIT SMART HOME LIFE
- 14 BLANKE ACTUATOR NC 230 V

Important note:

All the control system products can be found under SMART HOME from page 44.



BLANKE PERMATOP ECO

BLANKE PERMATOP ECO is a resource-saving, dry construction floor heating system with an installation height of 35 mm. Efficiency is the decisive factor with this system. The EPS-based system panels are factory-fitted with an aluminium heat diffusion plate. Heat diffusion plates are deliberately not installed onto the return panels. The system's metal composite piping is inserted into the prefabricated Omega loop with a pipe spacing of 16.6 cm. The use of raw materials is deliberately minimised here without detracting from the performance of the system. Thanks to the BLANKE PERMAT decoupling mat, the system offers high compressive stability. At the same time there is no need for screed, reducing the construction time by up to 4 weeks.

Advantages:

- > Very fast reacting surface heating and cooling system – perceptible warmth in the briefest of time
- > Low installation height – especially thin 35 mm
- > The drywall construction method means that no cement screed is used, resulting in significant savings of climate-damaging CO₂
- > Ideal for energy generators such as heat pumps
- > Resource-saving production of the elements: thin-layer aluminium heat diffusion plates and return panels without heat diffusion plates
- > Efficient installation gap of 16.6 cm

BLANKE PERMATOP ECO SET / INSTALLATION HEIGHT 35 MM INCL. BLANKE PERMAT (FOR TRAFFIC LOADS UP TO 5.0 KN/M²)

BLANKE PERMATOP ECO

Installation gap: 16.6 cm,
Thermal conductivity group WLS 035 PU: 1 set

Art. no.

651-900-6000-16

BLANKE PERMATOP ECO COMPONENTS

BLANKE PERMATOP ECO

STRAIGHT PANEL

10 pieces/PU
Panel dimension: 100 × 50 cm (0.50 m²)
Installation gap: 16.6 cm
Thermal conductivity group: WLS 035 PU: 10 pieces

Art. no.

651-900-6000-02

BLANKE PERMATOP ECO

EPS-INSULATION PANEL

16 pieces/PU
Panel dimension: 100 × 50 × 3 cm (0.50 m²)
Installation gap: 16.6 cm
Thermal conductivity group: WLS 035 PU: 16 pieces

Art. no.

214-900-03

BLANKE PERMATOP ECO

EDGE INSULATION STRIP

Length: 50 m PU: 1 roll

w=cm

10.0

Art. no.

214-900-02

BLANKE PERMATOP ECO

RETURN PANEL

10 pieces/PU
Panel dimension: 100 × 50 cm (0.50 m²)
6 elements per panel, Installation gap: 16.6 cm
Thermal conductivity group: WLS 035 PU: 10 pieces

Art. no.

651-900-6000-01

BLANKE PERMATOP ECO

COMPOSITE METAL PIPING

Dimensions: 16 × 2 mm PU: 1 roll

Length=m

300.0

500.0

Art. no.

651-900-1000-07

651-900-1000-04

BLANKE PERMAT

30 mats/carton
Dimensions: 97 × 62 cm PU: 1 carton

Art. no.

1 carton = 18 m²

1 pallet (11 × cartons) = 198 m²

1 pallet (334 × individual panels) = 200 m²

527-904

527-904

527-904-PAL

SYSTEM COMPONENTS RECOMMENDATION: FLOOR CONSTRUCTION



- 1 BLANKE PERMATOP ECO Straight panel
- 2 BLANKE PERMATOP ECO Return panel
- 3 BLANKE PERMATOP ECO Composite metal piping
- 4 BLANKE RDS
- 5 BLANKE GLUEMAX
- 6 BLANKE PERMAT

SYSTEM COMPONENTS RECOMMENDATION: HYDRAULICS



- 7 BLANKE HEATING CIRCUIT MANIFOLD VARIO
- 8 BLANKE MANIFOLD SHUT-OFF, SUPPLY (RED)
- 9 BLANKE MANIFOLD SHUT-OFF, RETURN FLOW (BLUE)
- 10 BLANKE MANIFOLD CABINET
- 11 BLANKE COMPRESSION FITTING

Important note:

All hydraulic products can be found under the respective product accessories and from page 38.

SYSTEM COMPONENTS RECOMMENDATION: CONTROL SYSTEM



- 12 BLANKE ROOM-CONTROL DEVICE SMART HOME LIFE
- 13 BLANKE BASE UNIT SMART HOME LIFE
- 14 BLANKE ACTUATOR NC 230 V

Important note:

All the control system products can be found under SMART HOME from page 44.



With this system you save raw materials

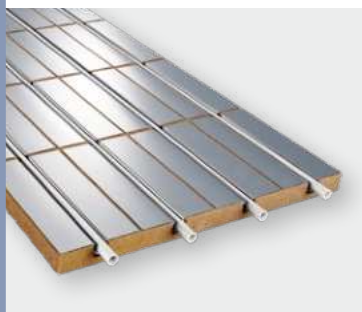

BLANKE PERMATOP NATURE

BLANKE PERMATOP NATURE is an ecological surface heating and cooling system with a system panel made with straw (installation height 35 mm). Straw is especially suitable as a system panel as the rapidly renewable raw material is readily available and is particularly eco-friendly. The system panel with the factory-fitted aluminium heat diffusion plate is complemented by high-quality metal composite piping.

The system also offers high compressive stability thanks to the BLANKE PERMAT decoupling mat, which is bonded using BLANKE GLUEMAX. This combination allows for a thin structure and fast heat distribution without the need for conventional screed. The ecological system panel features edge insulation strips made of corrugated board. This makes the system particularly suitable for sustainable buildings and green building projects.

Advantages:

- > Convenient and energy-efficient due to fast control response
- > System panel made from renewable raw materials
- > Solutions for new and renovated bathrooms with low installation heights
- > Short construction times thanks to the dry construction method
- > The dry construction method means that no cement screed is used, resulting in significant savings of climate-damaging CO₂



BLANKE PERMATOP NATURE SET / INSTALLATION HEIGHT 35 mm INCL. BLANKE PERMAT (FOR TRAFFIC LOADS UP 2.0 kN/m²)

BLANKE PERMATOP NATURE

Installation gap: 12.5 cm,
Thermal conductivity group 050 PU: 1 set

Art. no.

651-900-5000-12

BLANKE PERMATOP NATURE

Installation gap: 25.0 cm,
Thermal conductivity group 050 PU: 1 set

Art. no.

651-900-5000-25

Straw as a system panel? Naturally! The material offers outstanding characteristics. The quickly renewable raw material is available from regional farms. This means there are no restrictions in other areas, such as competition with arable land for food products. Straw also offers maximum sustainability due to its separability and recyclability. As an integral element of a surface heating/cooling system, the material contributes to providing the greatest possible comfort.



**SUSTAINABLE.
SAVES RESOURCES.**

SYSTEM COMPONENTS RECOMMENDATION: FLOOR CONSTRUCTION

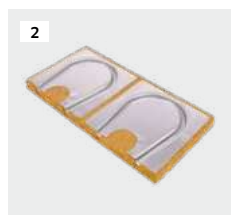

- 1 BLANKE PERMATOP NATURE
Straight panel
- 2 BLANKE PERMATOP NATURE
Return panel
- 3 BLANKE PERMATOP NATURE
Composite metal piping
- 4 BLANKE RDS
- 5 BLANKE GLUEMAX
- 6 BLANKE PERMAT



SYSTEM COMPONENTS RECOMMENDATION: HYDRAULICS



- 7 BLANKE HEATING CIRCUIT
MANIFOLD VARIO
- 8 BLANKE MANIFOLD SHUT-OFF,
SUPPLY (RED)
- 9 BLANKE MANIFOLD SHUT-OFF,
RETURN FLOW (BLUE)
- 10 BLANKE MANIFOLD CABINET
- 11 BLANKE COMPRESSION FITTING



Important note:
All hydraulic products can be found under the respective product accessories and from page 38.

SYSTEM COMPONENTS RECOMMENDATION: CONTROL SYSTEM



- 12 BLANKE ROOM-CONTROL
DEVICE SMART HOME LIFE
- 13 BLANKE BASE UNIT
SMART HOME LIFE
- 14 BLANKE ACTUATOR
NC 230 V

Important note:
All the control system products can be found under SMART HOME from page 44.

BLANKE PERMATOP WALL

PERMATOP WALL is a heating and cooling system for the wall that facilitates short construction times and impresses with top performance figures. The temperature of the heating or cooling agent is only slightly above or below that of the ambient air. The greater portion of energy is emitted as radiation, which significantly increases the perceived sense of comfort. This system combines perfectly with all other solutions available in the range of Blanke surface heating and cooling systems. The system is conceived for the installation of ceramic tiles. Optionally, decorative plaster effects may be applied as well.

BLANKE PERMATOP WALL SET / INSTALLATION HEIGHT 35 mm INCL. BLANKE PERMAT

Expert tip:

BLANKE PERMATOP WALL combines perfectly with all PERMATOP underfloor heating and cooling systems.

BLANKE PERMATOP WALL 12.5

Installation gap: 12.5 cm; Thermal conductivity group: WLS 035 PU: 1 set

Art. no.

658-900-12

BLANKE PERMATOP WALL 25

Installation gap: 25.0 cm; Thermal conductivity group: WLS 035 PU: 1 set

Art. no.

658-900-25

ACCESSORIES FOR BLANKE PERMATOP WALL

BLANKE COMPRESSION FITTING 16

FOR PERMATOP WALL

16 mm × 3/4" Eurocone PU: 2 pcs.

Art. no.

770-900-16

BLANKE COUPLING

FOR PERMATOP WALL

3/4 × 3/4" ET PU: 1 pc.

Art. no.

771-900



BLANKE COMPRESSION FITTING



BLANKE COUPLING



Image source: Steuffer Design

ALL-ROUND WARMTH WITH BLANKE PERMATOP WALL AND BLANKE UNDERFLOOR HEATING SYSTEMS

SYSTEM COMPONENTS RECOMMENDATION: FLOOR CONSTRUCTION



- 1 BLANKE PERMATOP WALL Straight panel
- 2 BLANKE PERMATOP WALL Return panel
- 3 BLANKE PIPE 16
- 4 BLANKE RDS
- 5 BLANKE GLUEMAX
- 6 BLANKE PERMAT



SYSTEM COMPONENTS RECOMMENDATION: HYDRAULICS



- 7 BLANKE HEATING CIRCUIT MANIFOLD VARIO
- 8 BLANKE MANIFOLD SHUT-OFF, SUPPLY (RED)
- 9 BLANKE MANIFOLD SHUT-OFF, RETURN FLOW (BLUE)
- 10 BLANKE MANIFOLD CABINET
- 11 BLANKE COMPRESSION FITTING



Important note:

All hydraulic products can be found under the respective product accessories and from page 38.

SYSTEM COMPONENTS RECOMMENDATION: CONTROL SYSTEM



- 12 BLANKE ROOM-CONTROL DEVICE SMART HOME LIFE
- 13 BLANKE BASE UNIT SMART HOME LIFE
- 14 BLANKE ACTUATOR NC 230 V

Important note:

All the control system products can be found under SMART HOME from page 44.

ACCESSORIES FOR BLANKE PERMATOP 1000, 3000, WOOD, ECO AND NATURE

Important note:

This accessory is compatible with PERMATOP systems 1000, 3000, WOOD, ECO and NATURE.

1. BLANKE COMPRESSION FITTING

FOR CONNECTING THE MULTILAYER COMPOSITE PIPE TO THE HEATING CIRCUIT MANIFOLD

16 mm × 3/4" Eurocone PU: 2 pcs.

Art. no.

767-900

2. BLANKE COMPRESSION CONNECTOR

STRAIGHT-TYPE, AS MOULDED PART FOR REPAIRS, FOR THE MULTILAYER COMPOSITE PIPE

16 × 2 mm PU: 1 pc.

Art. no.

689-900

3. BLANKE ELBOW ADAPTOR 90°

FOR THE MULTILAYER COMPOSITE PIPE

16 × 1/2" ET PU: 1 pc.

Version

Art. no.

Nipple

682-900-AG

4. BLANKE STRAIGHT ADAPTER

FOR THE MULTILAYER COMPOSITE PIPE

16 × 1/2" ET PU: 1 pc.

Version

Art. no.

Nipple

683-900-AG

5. BLANKE ELBOW ADAPTOR 90°

FOR THE MULTILAYER COMPOSITE PIPE

16 × 1/2" IT PU: 1 pc.

Version

Art. no.

Sleeve

682-900-IG

6. BLANKE STRAIGHT ADAPTER

FOR THE MULTILAYER COMPOSITE PIPE

16 × 1/2" IT PU: 1 pc.

Version

Art. no.

Sleeve

683-900-IG

7. BLANKE RDS

EDGE INSULATION STRIP

Length: 50 m PU: 1 roll

w=cm

Art. no.

10.0

214-900-02

8. BLANKE GLUEMAX

PU: 1 bag

Version

Art. no.

5 kg

603-900-5

18 kg

603-900

9. BLANKE PERMAT

30 mats/carton

Dimensions: 97×62 cm

PU: 1 carton

Art. no.

1 carton = 18 m²

527-904

1 pallet (11 × cartons) = 198 m²

527-904

1 pallet (334 × individual panels) = 200 m²

527-904-PAL

- 1 BLANKE COMPRESSION FITTING
- 2 BLANKE COMPRESSION CONNECTOR
- 3 BLANKE ELBOW ADAPTOR 90°
Version Nipple
- 4 BLANKE STRAIGHT ADAPTER
Version Nipple
- 5 BLANKE ELBOW ADAPTOR 90°
Version Sleeve
- 6 BLANKE STRAIGHT ADAPTER
Version Sleeve
- 7 BLANKE RDS
- 8 BLANKE GLUEMAX
- 9 BLANKE PERMAT



Important notes:

Use the matching press contours: TH / U / H / RF / MT

01

02

03

04

05

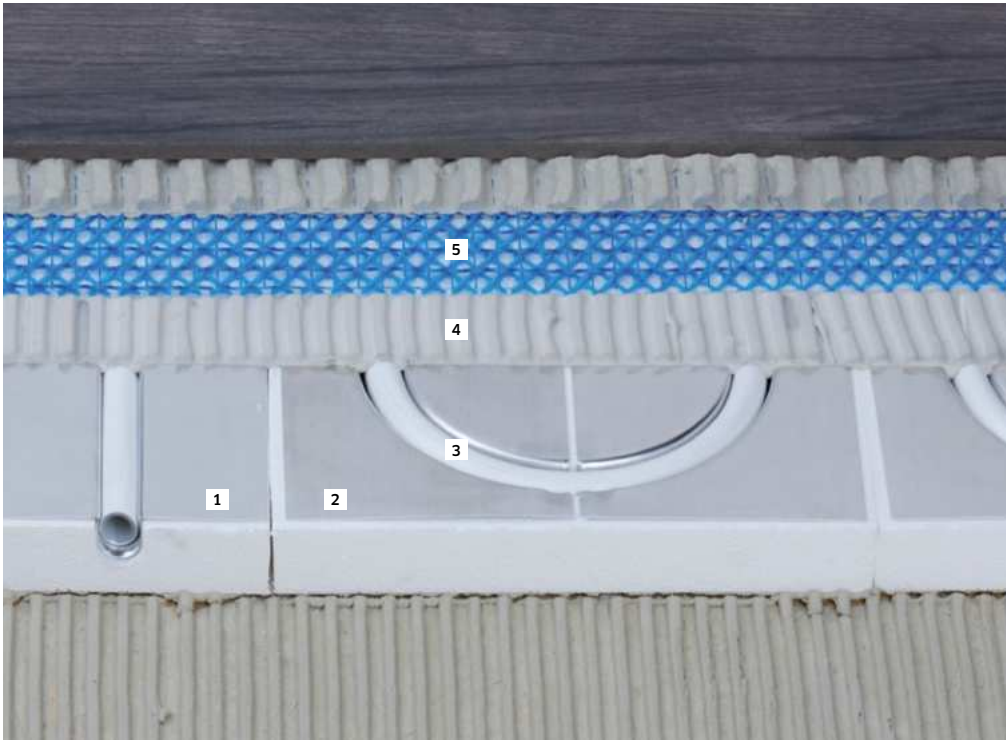

Design of our dry construction systems:

- 1 Grooved panel
- 2 Return panel
- 3 Composite metal pipe 16×2 mm
- 4 BLANKE GLUEMAX - special fast curing dispersion adhesive
- 5 BLANKE PERMAT - underlayment and decoupling mat

Not illustrated, but part of the system: Edge insulation strip

Cross-section BLANKE PERMATOP 1000/3000/ WOOD/ECO/NATURE
installation height 35/31 mm

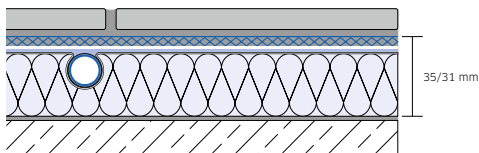

Cross-section: conventional underfloor heating,
installation height from approx. 85 mm

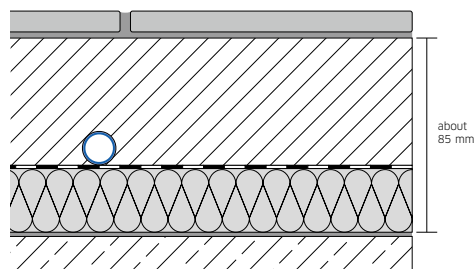

Important notes:



TOOLS FOR SURFACE HEATING SYSTEMS FROM BLANKE



Important notes:

We recommend suitable tools for installing BLANKE surface heating systems easily and reliably.

- 7 BLANKE Uncoiler
- 8 BLANKE EPS groove cutter
- 9 BLANKE Replacement blade for BLANKE EPS groove cutter
- 10 BLANKE Pipe shears
- 11 BLANKE Pipe bevelling tool

For all product details refer to page 68 onwards.

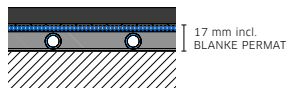
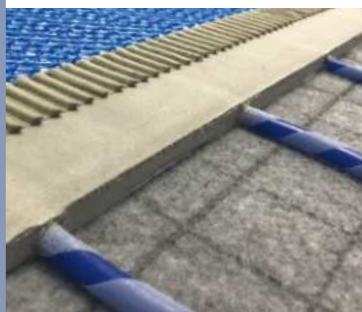

BLANKE PERMATOP SF Advantages at a glance:

- > Minimal installation height of just 12 mm; 17 mm top edge BLANKE PERMAT
- > Fast-reacting
- > Very short drying time
- > Quick installation with zero waiting time
- > Easy levelling thanks to the integrated energy distribution layer BLANKE SF FILLER

Important notes:

10 lm of BLANKE SF KLETT-TEC per m² is required for an installation gap of 10 cm. 20 lm of BLANKE SF KLETT-TEC per m² is required for an installation gap of 5 cm. The additional requirement for BLANKE SF FILLER is approx. 1 mm/m² = 1.60 kg. The maximum height of the SF FILLER beginning at the SK fibre-mesh mat SF BASE is 20 mm.

More information about BLANKE PERMAT is available from page 64 onwards.
More information about BLANKE SF FILLER is available on page 66.

The matching heating circuit manifolds can be found from page 38 and the matching SMART HOME components from page 44.

Expert tip:

BLANKE PERMATOP SF combines perfectly with BLANKE PERMATOP WALL (page 26).

BLANKE PERMATOP SF

BLANKE PERMATOP SF for tiles and natural stone floor coverings is a modular combination of perfectly matching individual components for use in heating and cooling rooms. It consists of a self-levelling energy distribution layer BLANKE SF FILLER with integrated water-carrying heating and cooling pipework made of a high-quality PE heating pipe, which makes it with Velcro extremely easy to lay onto the self-adhesive fibre mat. PERMATOP SF should be supplemented with the BLANKE PERMAT, which has proven itself over many years as a reinforcing underlayment and decoupling mat.

BLANKE SF BASE SA FIBRE-MESH MAT

roll = 21 m²

PU: 1 roll

l=m	b=m	Art. no.
20.00	1.05	684-900

BLANKE SF KLETT-TEC

HEATING AND COOLING PIPE WITH 5-LAYER TECHNOLOGY

Ø = 10 × 1.3 mm

PU: 1 roll

lm	Art. no.
70	686-904-070
120	686-904-120
500	686-904-500

BLANKE RDS 5/50

EDGE INSULATION STRIP WITH SELF-ADHESIVE BASE

Dimensions: 5 × 50 mm

PU: 1 roll

lm	Art. no.
25	685-900

BLANKE BENDS 10

FOR 10 mm PIPE BLANKE SF KLETT-TEC

PU: 1 pc.

Art. no.
990-900-10

ACCESSORIES FOR BLANKE PERMATOP SF

BLANKE SF COMPRESSION FITTING FOR BLANKE PERMATOP SF

10 mm × 3/4" Eurocone

PU: 2 pcs.

Art. no.

770-900-10

BLANKE COUPLING

FOR BLANKE PERMATOP SF/SF 14

3/4" × 3/4" ET

PU: 1 pc.

Art. no.

771-900

BLANKE SF FILLER ENERGY DISTRIBUTION LAYER

1 bag = 25 kg

PU: 1 bag

Art. no.

604-900

BLANKE PERMAT

30 mats/carton

Dimensions: 97 × 62 cm

PU: 1 carton

Art. no.

1 carton = 18 m²

527-904

1 pallet (11 × cartons) = 198 m²

527-904

1 pallet (334 × individual panels) = 200 m²

527-904-PAL

SYSTEM COMPONENTS RECOMMENDATION: FLOOR CONSTRUCTION



- 1 BLANKE SF BASE
- 2 BLANKE RDS 5/50
- 3 BLANKE SF KLETT-TEC
10x1.3 mm

SYSTEM COMPONENTS RECOMMENDATION: HYDRAULICS



- 4 BLANKE HEATING CIRCUIT
MANIFOLD VARIO
- 5 BLANKE MANIFOLD SHUT-OFF
SUPPLY (RED)
- 6 BLANKE MANIFOLD SHUT-OFF
RETURN FLOW (BLUE)
- 7 BLANKE MANIFOLD CABINET UP
- 8 BLANKE Y-JUNCTION CONNECTOR
- 9 BLANKE BENDS 10 mm
- 10 BLANKE SF COMPRESSION
FITTING

Advantage:

Use BLANKE BENDS to easily and reliably insert BLANKE SF KLETT-TEC into the SF FILLER energy distribution layer.

Important note:

All hydraulic products can be found under the respective product accessories and from page 38.

SYSTEM COMPONENTS RECOMMENDATION: CONTROL SYSTEM



- 11 BLANKE ROOM-CONTROL
DEVICE SMART HOME LIFE
BLACK
- 12 BLANKE BASE UNIT
SMART HOME LIFE ZONES
- 13 BLANKE ACTUATOR NC 230 V

Important note:

All the control system products can be found under SMART HOME from page 44.

SYSTEM COMPONENTS RECOMMENDATION: ADDITIONAL PRODUCTS



- 14 BLANKE SF FILLER
- 15 BLANKE PERMAT

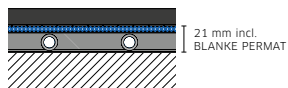

BLANKE PERMATOP SF 14 Advantages at a glance:

- > Renovation system, applied to existing floor
- > Low weight per unit area of approx. 30 kg/m² without floor covering and minimal installation height of just 21 mm including BLANKE PERMAT
- > Fast response times in heating or cooling mode
- > Quick and easy installation without long drying times
- > All components for the floor construction are harmonised and from one supplier

Important notes:

10 lm of BLANKE SF KLETT-TEC per m² is required for an installation gap of 10 cm. 20 lm of BLANKE SF KLETT-TEC per m² is required for an installation gap of 5 cm. For installation heights that exceed 1 mm pipe covering of the 14 mm heating pipe, additional FILLOTHERM is required per 1 mm/m² = 1.9 kg/m². The maximum height of the FILLOTHERM beginning at the adhesive fibre mesh mat SF BASE is 25 mm.

More information about BLANKE PERMAT is available from page 64 onwards. More information about BLANKE FILLOTHERM is available on page 67.

The matching heating circuit manifolds can be found from page 38 and the matching SMART HOME components from page 44.

BLANKE PERMATOP SF 14

BLANKE PERMATOP SF 14 is a thin-layered surface heating and cooling system with an installation height of 21 mm that is ideal for renovation projects. The system is laid directly on the old installed floor covering. This not only saves valuable time and removal costs, but also reduces the amount of noise and dust during the renovation.

This system has three key components: the self-adhesive fibre mesh mat, the high-quality 14 mm 5-layer PE pipe with Velcro sheathing, and the fast-curing BLANKE FILLOTHERM energy distribution layer. The Velcro connection makes the piping particularly easy to install. The BLANKE PERMATOP SF 14 should be completed with the BLANKE PERMAT reinforcing underlay and decoupling mat. We recommend combining the thin-layer surface heating and cooling system with a tile or natural stone covering for maximum efficiency.

BLANKE SF BASE SA FIBRE-MESH MAT

roll = 21 m²

PU: 1 roll

l=m	w=m	Art. no.
20.00	1.05	684-900

BLANKE RDS 5/50

EDGE INSULATION STRIP WITH SELF-ADHESIVE BASE

Dimensions: 5 × 50 mm

PU: 1 roll

lm	Art. no.
25	685-900

BLANKE SF 14 KLETT-TEC

HEATING AND COOLING PIPE WITH 5-LAYER TECHNOLOGY

Ø = 14 × 2.0 mm

PU: 1 roll

lm	Art. no.
120	653-904-120
500	653-904-500

BLANKE BENDS 14/16

FOR BLANKE SF 14 KLETT-TEC, PIPE 14 AND 16

PU: 1 pc.

Art. no.
990-900-16

ACCESSORIES FOR BLANKE PERMATOP SF 14

BLANKE SF COMPRESSION FITTING

FOR BLANKE PERMATOP SF

14 mm × 3/4" Eurocone

PU: 2 pcs.

Art. no.

657-900-14

BLANKE COUPLING

FOR BLANKE PERMATOP SF/SF 14

3/4" × 3/4" ET

PU: 1 pc.

Art. no.

771-900

BLANKE FILLOTHERM

FAST-CURING ENERGY DISTRIBUTION LAYER
FOR BLANKE PERMATOP SF 14, BF+ AND BFC

1 bag = 25 kg

PU: 1 bag

Art. no.

674-900

BLANKE PERMAT

30 mats/carton

Dimensions: 97 × 62 cm

PU: 1 carton

Art. no.

1 carton = 18 m²

527-904

1 pallet (11 × cartons) = 198 m²

527-904

1 pallet (334 × individual panels) = 200 m²

527-904-PAL

SYSTEM COMPONENTS RECOMMENDATION: FLOOR CONSTRUCTION



- 1 BLANKE SF BASE
- 2 BLANKE RDS 5/50
- 3 BLANKE SF 14 KLETT-TEC 14x2 mm

SYSTEM COMPONENTS RECOMMENDATION: HYDRAULICS



- 4 BLANKE HEATING CIRCUIT MANIFOLD VARIO
- 5 BLANKE MANIFOLD SHUT-OFF SUPPLY (RED)
- 6 BLANKE MANIFOLD SHUT-OFF RETURN FLOW (BLUE)
- 7 BLANKE MANIFOLD CABINET UP
- 8 BLANKE Y-JUNCTION CONNECTOR
- 9 BLANKE BENDS 14/16 mm
- 10 BLANKE SF COMPRESSION FITTING

Advantage:

Use BLANKE BENDS to easily and reliably insert BLANKE SF 14 KLETT-TEC into the BLANKE FILLO-THERM energy distribution layer.

Important note:

All hydraulic products can be found under the respective product accessories and from page 38.

SYSTEM COMPONENTS RECOMMENDATION: CONTROL SYSTEM



- 11 BLANKE ROOM-CONTROL DEVICE SMART HOME LIFE BLACK
- 12 BLANKE BASE UNIT SMART HOME LIFE
- 13 BLANKE ACTUATOR NC 230 V

Important note:

All the control system products can be found under SMART HOME from page 44.

SYSTEM COMPONENTS RECOMMENDATION: ADDITIONAL PRODUCTS



- 14 BLANKE FILLO-THERM
- 15 BLANKE PERMAT



BLANKE PERMATOP BF, BF+ AND BFC

The BLANKE PERMATOP BF series is a family of surface heating and cooling systems for commercially available screeds. The systems comprise studded panels made from pressure-resistant polystyrene. These are used to accommodate the extremely flexible BLANKE PIPE 14 and BLANKE PIPE 16 heating pipes. Both of the system's PE-RT heating pipes boast a laminated oxygen barrier layer (EVOH) on the inside, which, as a consequence, protects it from damage. The system is rounded off with the tried-and-trusted BLANKE PERMAT decoupling mat, which is used for surface floors such as tiling and natural stone.

The BLANKE PERMATOP BF+ features 10 mm thick integrated thermal insulation (WLS 035).

BLANKE PERMATOP BFC features thermal and footfall sound insulation 30-2 (WLS 040).

Important notes:

BLANKE PERMATOP BF+ and BFC are suitable for fluid screeds such as the fast-curing BLANKE FILLO-THERM energy distribution layer.

The studded screed support panel BFC includes a DES sg insulation layer with an impact sound level reduction up to 28 dB.

Suitable accessories for BLANKE PERMATOP BF, BF+ and BFC are listed on page 36.

8 mm screed coverage of the studded screed panel with tiles incl. BLANKE PERMAT; for alternative floor coverings, 15 mm screed coverage of the studded screed panel

BLANKE BF BASE STUDDED SCREED PANEL

Usable dimension: 140 × 80 cm, Useful floor area: 1.12 m²
Panel dimension: 145 × 85 cm
Total height: 20 mm

	PU: 1 carton
	Art. no.
1 carton with 12 panels = 13.44 m ²	680-906

BLANKE BF+ BASE STUDDED SCREED PANEL INCL. THERMAL INSULATION

Usable dimension: 140 × 80 cm, Useful floor area: 1.12 m²
Panel dimension: 145 × 85 cm
Material thickness: 0.6 mm; Total height: 31 mm
Thermal conductivity group: WLS 035

	PU: 1 carton
	Art. no.
1 carton with 13 panels = 14.56 m ²	671-906

BLANKE BFC BASE STUDDED SCREED PANEL INCL. THERMAL & FOOTFALL SOUND INSULATION

Usable dimension: 140 × 80 cm,
Useful floor area: 1.12 m², Panel dimension: 145 × 85 cm;
Material thickness: 0.6 mm; Height: 51 mm;
Thermal conductivity group: WLS 040

	PU: 1 carton
	Art. no.
1 carton with 6 panels = 6.72 m ²	681-906

SYSTEM COMPONENTS RECOMMENDATION: FLOOR CONSTRUCTION

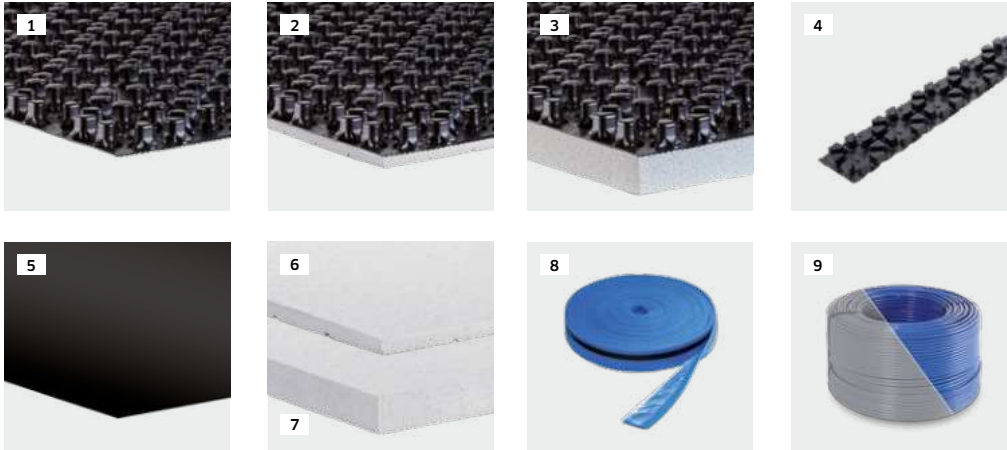

- 1 BLANKE PERMATOP BF
- 2 BLANKE PERMATOP BF+
- 3 BLANKE PERMATOP BFC
- 4 BLANKE CONNECTION ELEMENT
- 5 BLANKE FLATBASE
- 6 BLANKE DP 10
(only for PERMATOP BF+)
- 7 BLANKE DP 30
(only for PERMATOP BFC)
- 8 BLANKE RDS 10/120
- 9 BLANKE PIPE 14/16

SYSTEM COMPONENTS RECOMMENDATION: HYDRAULICS



- 10 BLANKE HEATING CIRCUIT MANIFOLD VARIO
- 11 BLANKE MANIFOLD SHUT-OFF, SUPPLY (RED)
- 12 BLANKE MANIFOLD SHUT-OFF, RETURN FLOW (BLUE)
- 13 BLANKE MANIFOLD CABINET UP
- 14 BLANKE BENDS 14/16 mm
- 15 BLANKE COMPRESSION FITTING

Important note:

All hydraulic products can be found under the respective product accessories and from page 38.

SYSTEM COMPONENTS RECOMMENDATION: CONTROL SYSTEM



- 16 BLANKE ROOM-CONTROL DEVICE SMART HOME LIFE BLACK
- 17 BLANKE BASE UNIT SMART HOME LIFE 10 ZONES
- 18 BLANKE ACTUATOR NC 230 V

Important note:

All the control system products can be found under SMART HOME from page 44.

COMPLEMENTARY PRODUCTS



- 19 BLANKE FILLTHERM
- 20 BLANKE RDS 10/120 SK

Important note:

Our BLANKE FILLTHERM supplements the BLANKE PERMATOP BF+ and BLANKE PERMATOP BFC systems as an energy distribution layer. BLANKE FILLTHERM may not be used with BLANKE PERMATOP BF.



Expert tip:

When installing tightly spaced heating pipes, BLANKE FLATBASE in combination with an insulation board DP 10 (when using BF+) or DP 30 (when using BFC) compensates height differences and offers a smooth surface to easily route BLANKE PIPE 14 or 16 to the heating circuit manifold or to the area around doorways.

Use the double-sided adhesive tape BLANKE SK TAPE* to stick BLANKE BF BASE, BF+ BASE and BFC BASE to the smooth manifold connection panel BLANKE FLATBASE.

*Approved screeds as specified in the technical data sheets.

Important note:

The matching heating circuit manifolds can be found from page 38 and the matching SMART HOME components from page 44.

Expert tip:

BLANKE PIPE CLIPS serve as self-adhesive holders to affix the heating pipes BLANKE PIPE 14 or 16 to the smooth surface of BLANKE PERMATOP FLATBASE manifold connection panel.

The 100 cm-long BLANKE PIPE CLIPS can be separated into 20 cm-wide pieces. There are 4 pipe fixing points provided on each of the 20 cm-wide BLANKE PIPE CLIPS.

ACCESSORIES FOR BLANKE PERMATOP BF, BF+ AND BFC

Discover the accessories for the BLANKE PERMATOP BF, BF+, BFC. Here you will find connecting elements, edge insulating strips, hydraulic components and insulating panels. Using components from the same supplier results in a reliable, heated floor construction.

1. BLANKE FLATBASE

SMOOTH MANIFOLD CONNECTION PANEL

Panel dimension: 120 × 80 cm = 0.96 m²

Material thickness: 0.6 mm

PU: 1 pc.

Art. no.

1 panel = 0.96 m²

670-906

3. BLANKE DP 10

INSULATION PANEL FOR PERMATOP BF+

Panel dimension: 120 × 80 cm; Material thickness: 10.0 mm

Thermal conductivity group: WLS 038

PU: 1 pc.

Art. no.

1 panel = 0.96 m²

662-900-120801

5. BLANKE RDS 10/120

EDGE INSULATION STRIP FOR PERMATOP BF, BF+ AND BFC INCL. BASE UNDERLAYMENT FOR SEMI-DRY SCREEDS

Dimensions: 10 × 120 mm

PU: 1 roll

1m

Art. no.

50

702-900

7. BLANKE PIPE 14

HEATING AND COOLING PIPE WITH 5-LAYER TECHNOLOGY

Ø = 14 × 2 mm, Colour: gray

PU: 1 roll

1m

Art. no.

70

661-909-070

120

661-909-120

200

661-909-200

600

661-909-600

9. BLANKE COMPRESSION FITTING 14

FOR PERMATOP BF, BF+ AND BFC

14 mm × 3/4" Eurocone

PU: 2 pcs.

Art. no.

657-900-14

11. BLANKE PIPE CLIPS

SELF-ADHESIVE PIPE CLIPS TO CLIP IN BLANKE PIPE 14 AND 16

L = 100 cm

PU: 1 pc.

Art. no.

647-900

2. BLANKE SK TAPE

DOUBLE-SIDED ADHESIVE TAPE TO STICK BF BASE, BF+ BASE AND BFC BASE TO BLANKE FLATBASE

Dimensions: l = 50 m × w = 22 mm, Thickness: 1 mm

PU: 1 roll

Art. no.

364-900-22

4. BLANKE DP 30

INSULATION PANEL FOR PERMATOP BFC

Panel dimension: 120 × 80 cm; Material thickness: 30.0 mm

Thermal conductivity group: WLS 038

PU: 1 pc.

Art. no.

1 panel = 0.96 m²

662-900-120803

6. BLANKE RDS 10/120 SK

SELF-ADHESIVE EDGE INSULATION STRIPS FOR PERMATOP BF+ AND BFC INCL. UNDERLAYMENT FOR FLOWING SCREEDS (NOT FOR BF)

Dimensions: 10 × 120 mm

PU: 1 roll

1m

Art. no.

50

646-900

8. BLANKE PIPE 16

HEATING AND COOLING PIPE WITH 5-LAYER TECHNOLOGY

Ø = 16 × 2 mm, Colour: blue

PU: 1 roll

1m

Art. no.

70

687-904-070

120

687-904-120

200

687-904-200

600

687-904-600

10. BLANKE COMPRESSION FITTING 16

FOR PERMATOP BF, BF+ AND BFC

16 mm × 3/4" Eurocone

PU: 2 pcs.

Art. no.

770-900-16

12. BLANKE BENDS 14/16

FOR BLANKE PIPE 14 AND 16

PU: 1 pc.

Art. no.

990-900-16

13. BLANKE COUPLING

COUPLING FOR PIPE 14/16

3/4 × 3/4" ET

PU: 1 pc.

Art. no.

771-900

15. BLANKE DOOR ELEMENT

FOR BASE STUDDED PANELS

Usable dimension: 140 × 20 cm

PU: 1 carton with 14 pcs.

Art. no.

642-906

17. BLANKE FILLOTHERM

FAST-CURING ENERGY DISTRIBUTION LAYER
FOR BLANKE PERMATOP BF+, BFC AND SF 14

1 bag = 25 kg

PU: 1 bag

Art. no.

674-900

14. BLANKE CONNECTION ELEMENT

FOR BASE STUDDED PANELS

Usable dimension: 140 × 10 cm

PU: 1 carton with 20 pcs.

Art. no.

638-906

16. BLANKE PERMAT

30 mats/carton

Dimensions: 97 × 62 cm

PU: 1 carton

Art. no.

1 carton = 18 m²

527-904

1 pallet (11 × cartons) = 198 m²

527-904

1 pallet (334 × individual panels) = 200 m²

527-904-PAL



Expert tip:

The BLANKE CONNECTION ELEMENT is used to easily and reliably connect studded panels in the BLANKE BASE range and to reduce waste.



Expert tip:

The BLANKE DOOR ELEMENT is ideal for use around doorways.



14 mm × 3/4" EUROCONE



16 mm × 3/4" EUROCONE



1 BLANKE FLATBASE

2 BLANKE SK TAPE

3 BLANKE DP 10

4 BLANKE DP 30

5 BLANKE RDS 10/120

6 BLANKE RDS 10/120 SK

7 BLANKE PIPE 14

8 BLANKE PIPE 16

9 BLANKE COMPRESSION

FITTING 14

10 BLANKE COMPRESSION

FITTING 16

11 BLANKE PIPE CLIPS

12 BLANKE BENDS

13 BLANKE COUPLING

14 BLANKE CONNECTION

ELEMENT

15 BLANKE DOOR ELEMENT

16 BLANKE PERMAT

17 BLANKE FILLOTHERM

(not suitable for PERMATOP BF)

Important note:

The BLANKE PERMAT decoupling and underlayment mat is required for tile surfaces.



02

03

HYDRAULICS

04

05

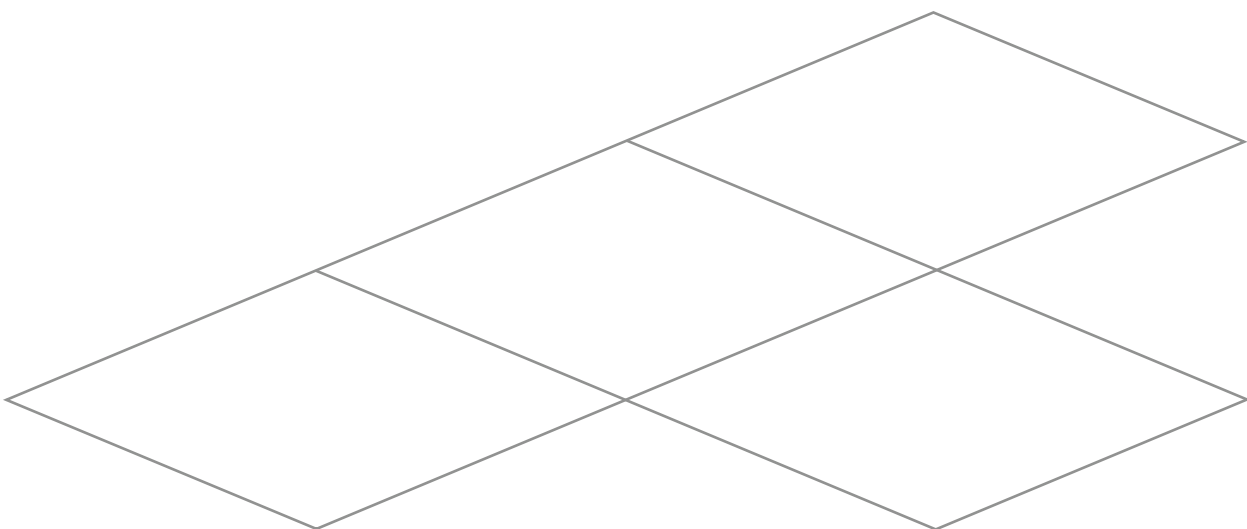



40 BLANKE HEATING
CIRCUIT MANIFOLD
VARIO

02

03

04

05

BLANKE HEATING CIRCUIT MANIFOLD VARIO

The BLANKE HEATING CIRCUIT MANIFOLD VARIO made of high-quality stainless steel is already preassembled. If required, heating circuits can also be subsequently installed using the extension set. The proven valve technology and additional flow rate indicators provide for ideal control capability. When coordinated with BLANKE SMART HOME products, the hydraulic calibration can be performed independently and fully automatically. The combination of the BLANKE HEATING CIRCUIT MANIFOLD VARIO and smart home control system is eligible for subsidies in accordance with BAFA guidelines and has been certified by TÜV Rheinland.

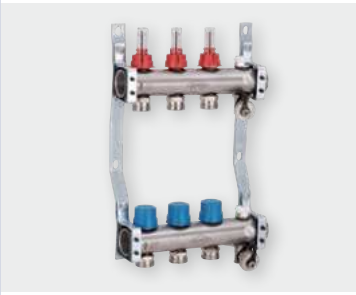

BLANKE HEATING CIRCUIT MANIFOLD VARIO advantages at a glance:

- > Stainless steel design for corrosion resistance
- > Optimised pump performance due to low pressure losses
- > Rugged, resilient valve technology in case of adverse heating water quality
- > Flow rate display for exact pre-setting of the volumetric flow rate per heating circuit
- > Preassembled version
- > Modular expandability

Important notes:

Please note that the manifold shut-off valves are available in DN 25 (R 1") and DN 20 (R 3/4").

Suitable distributor cabinets are listed on page 43.

1. BLANKE HEATING CIRCUIT MANIFOLD VARIO

Stainless steel		PU: 1 pc.
Number of heating circuits	Art. no.	
2	979-900-02	
3	979-900-03	
4	979-900-04	
5	979-900-05	
6	979-900-06	
7	979-900-07	
8	979-900-08	
9	979-900-09	
10	979-900-10	
11	979-900-11	
12	979-900-12	

2. BLANKE HEATING CIRCUIT MANIFOLD VARIO EXTENSION SET

Stainless steel		PU: 1 pc.
Number of heating circuits	Art. no.	
1	969-900	

3. BLANKE MANIFOLD SHUT-OFF VALVE

SUPPLY (RED)

Stainless steel		PU: 1 pc.
Size	Art. no.	
3/4" IT x 1" ET	937-900	
1" IT x 1" ET	931-900	

4. BLANKE MANIFOLD SHUT-OFF VALVE

RETURN FLOW (BLUE)

Stainless steel		PU: 1 pc.
Size	Art. no.	
3/4" IT x 1" ET	938-900	
1" IT x 1" ET	932-900	

5. BLANKE CONNECTION SET ELBOW

PLACEHOLDER FOR HEAT METER

Shut-off valve DN 25		PU: 1 pc.
Art. no.		
934-900		

6. BLANKE CONNECTION SET STRAIGHT

PLACEHOLDER FOR HEAT METER

Shut-off valve DN 25		PU: 1 pc.
Art. no.		
935-900		

7. BLANKE FIXED-VALUE CONTROL STATION

WITH HIGH-EFFICIENCY PUMP TO CONNECT TO THE HEATING CIRCUIT MANIFOLD

2 to 12 port		PU: 1 pc.
Art. no.		
936-900		

8. BLANKE SEPARATOR

SLUDGE AND MAGNETIC SEPARATOR

R 3/4" IT		PU: 1 pc.
Art. no.		
966-900		

9. BLANKE BALANCING VALVE

INCL. CONNECTOR (1" ET/1" ET)

		PU: 1 pc.
Art. no.		
992-900		

10. BLANKE REDUCER

1" ET AND 3/4" IT

		PU: 1 pc.
Dimensions	Art. no.	
1" ET x 3/4" IT	991-900	

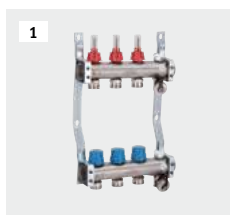

- 1 BLANKE HEATING CIRCUIT MANIFOLD VARIO
- 2 BLANKE HEATING CIRCUIT MANIFOLD VARIO EXTENSION SET
- 3 BLANKE MANIFOLD SHUT-OFF VALVE SUPPLY (RED)
- 4 BLANKE MANIFOLD SHUT-OFF VALVE RETURN FLOW (BLUE)
- 5 BLANKE CONNECTION SET ELBOW (PWZ)
- 6 BLANKE CONNECTION SET STRAIGHT (PWZ)
- 7 BLANKE FIXED-VALUE CONTROL STATION with high-efficiency pump
- 8 BLANKE SEPARATOR
- 9 BLANKE BALANCING VALVE INCL. CONNECTOR (1" ET/1" ET)
- 10 BLANKE REDUCER 1" ET X 3/4" IT

Important note:

Please note that the manifold shut-off valves are available in DN 25 (R 1") and DN 20 (R 3/4").



ACCESSORIES FOR ALL BLANKE PERMATOP SYSTEMS

11. BLANKE MIKRO-LBA
MICROBUBBLE DEAERATOR

R 3/4" IT PU: 1 pc.

Art. no.
 967-900

12. BLANKE THERMAL INSULATION SHELLS
SLUDGE AND MAGNETIC SEPARATOR

Suitable for SEPARATOR and MIKRO-LBA PU: 1 pc.

Art. no.
 968-900

13. BLANKE RETURN FLOW TEMPERATURE LIMITER VALVE
FOR FLOOR TEMPERATURE CONTROL

PU: 1 pc.

Art. no.
 985-900

14. BLANKE DESIGN RETURN TEMPERATURE LIMITER VALVE BLACK

RTL WITH REAL GLASS COVER IN BLACK PU: 1 pc.

Art. no.
 945-906

15. BLANKE DESIGN RETURN TEMPERATURE LIMITER VALVE WHITE

RTL WITH REAL GLASS COVER WHITE PU: 1 pc.

Art. no.
 945-901

16. BLANKE MIXING UNIT
INCL. HIGH-EFFICIENCY PUMP AND TEMPERATURE CONTROL VALVE

PU: 1 pc.

Art. no.
 986-900

17. BLANKE Y-JUNCTION CONNECTOR
EUROCONE 3/4" FOR CONNECTING TO THE MIXING UNIT AND TO THE HCM

Suitable only for 10 × 1.3 mm heating pipe PU: 1 pc.

Art. no.
 987-900

18. BLANKE ADAPTER FITTING
EUROCONE 3/4" IT TO 1/2" ET

PU: 1 pc.

Art. no.
 988-900

Important note:

The BLANKE Y-JUNCTION CONNECTORS are only suitable for connecting to the Blanke heating circuit manifolds in conjunction with the Klett-TEC heating pipe 10 × 1.3 mm (mixing unit 16/14 mm also possible). They are not suitable for use with a return temperature limiter valve.

- 11 BLANKE MIKRO-LBA
- 12 BLANKE THERMAL INSULATION SHELLS
- 13 BLANKE RETURN FLOW TEMPERATURE LIMITER VALVE
- 14 BLANKE DESIGN RETURN TEMPERATURE LIMITER VALVE BLACK with real glass cover in black
- 15 BLANKE DESIGN RETURN TEMPERATURE LIMITER VALVE WHITE with real glass cover in white
- 16 BLANKE MIXING UNIT
- 17 BLANKE Y-JUNCTION CONNECTOR
- 18 BLANKE ADAPTER FITTING



MANIFOLD CABINETS AND ACCESSORIES FOR BLANKE PERMATOP SYSTEMS

19. BLANKE MANIFOLD CABINET UP
FLUSH-MOUNTED

h = 750 - 850 × d = 110 - 165 mm

PU: 1 pc.

w=mm	Art. no.
550	983-900-0550
700	983-900-0700
850	983-900-0850
1000	983-900-1000
1200	983-900-1200

20. BLANKE MANIFOLD CABINET AP
SURFACE-MOUNTED

h = 710 - 850 × d = 140 mm

PU: 1 pc.

w=mm	Art. no.
550	984-900-0550
700	984-900-0700
850	984-900-0850
1000	984-900-1000
1200	984-900-1200

Important note:

BLANKE MANIFOLD CABINETS are designed to house BLANKE HEATING CIRCUIT MANIFOLDS.

You can choose between UP (flush-mounted) when installing in the wall and AP (surface-mounted) when installing on the wall. All manifold cabinets are in the colour RAL 9016.

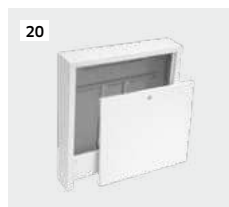

19 BLANKE MANIFOLD CABINET UP FLUSH-MOUNTED
20 BLANKE MANIFOLD CABINET AP SURFACE-MOUNTED





03

SMART HOME CONTROLLERS FOR SURFACE HEATING AND COOLING SYSTEMS

04

05



03



46 BLANKE SMART HOME LIFE



48 BLANKE CONTROL 230

04

05



BLANKE SMART HOME LIFE

The future of indoor climate solutions lies in smart systems that are ideally adapted to meet the user's needs and are characterised by modular expandability, flexibility and sustainability. The Blanke Smart Home Life system with its cloud-capable product and system solutions meets all the requirements of a future-oriented technology for the Internet of Things (IoT).

Blanke Smart Home Life - everything is automatic, everything stays under control with the all-in-one package of hardware, software and cloud solutions from a single source: The perfect introduction to your digital portfolio for a modern smart home.

Important note:

Suitable for heating and cooling functions.

1. BLANKE BASE UNIT SMART HOME LIFE

FOR CONTROLLING UP TO 10 ROOM-CONTROL DEVICES; SUPPLY VOLTAGE: 230 V

PU: 1 pc.

Number of room-control devices	Art. no.
6	978-900-06
10	978-900-10

2. BLANKE ROOM-CONTROL DEVICE SMART HOME LIFE BLACK

SUPPLY VOLTAGE: 2 × 1.5 V LR03/MICRO/AAA

PU: 1 pc.

Version	Art. no.
digital, black	970-906

3. BLANKE ROOM-CONTROL DEVICE SMART HOME LIFE WHITE

SUPPLY VOLTAGE: 2 × 1.5 V LR03/MICRO/AAA

PU: 1 pc.

Version	Art. no.
digital, white	971-901

4. BLANKE GATEWAY SMART HOME LIFE

FOR APP OPERATION

PU: 1 pc.

Version	Art. no.
Gateway with 230V/5V power supply unit	977-901

5. BLANKE ACTUATOR 230 V

THERMAL ACTUATOR A5.
230 V NC, 4.0 MM ACTUATOR TRAVEL, VA 80
THREAD: M30 × 1.5 MM

PU: 1 pc.

Art. no.
963-900



1



2

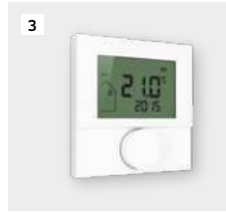

3



4

- 1 BLANKE BASE UNIT
SMART HOME LIFE 6/10 ZONES
- 2 BLANKE ROOM-CONTROL
DEVICE SMART HOME LIFE
BLACK
- 3 BLANKE ROOM-CONTROL
DEVICE SMART HOME LIFE
WHITE
- 4 BLANKE GATEWAY
SMART HOME LIFE
- 5 BLANKE ACTUATOR 230 V



5



BLANKE CONTROL 230

The basic prerequisite for an ideally functioning surface temperature control is a demand-oriented, energy-saving individual room controller with high control accuracy, which adjusts the heating and cooling performance to perfectly suit the user's requirements. The BLANKE CONTROL 230 system is a wired individual room controller in a modern design. All the components of this classically wired individual room controller can be used both as stand-alone elements as well as in the overall system. Combining the controller and base versions into an individual room control system allows both simple as well as complex requirements for heating and cooling applications to be realised which leave nothing to be desired (connection cable: NYM 5 × 1.5 mm²).



Important note:

An additional floor sensor is recommended for effective controlling.

1. BLANKE BASE UNIT 230

FOR CONTROLLING 6-10 ROOM-CONTROL DEVICES;
SUPPLY VOLTAGE: 230 V

		PU: 1 pc.
Number of room-control devices	Art. no.	
6	925-900-06	
10	925-900-10	

2. BLANKE ROOM-CONTROL DEVICE 230, WHITE

SUPPLY VOLTAGE: 230 V

		PU: 1 pc.
Version	Art. no.	
digital, white	926-900	

3. BLANKE ROOM-CONTROL DEVICE 230, BLACK

SUPPLY VOLTAGE: 230 V

		PU: 1 pc.
Version	Art. no.	
digital, black	927-900	

4. BLANKE ROOM-CONTROL DEVICE 230, WHITE

SUPPLY VOLTAGE: 230 V
WITH INTEGRATED CLOCK FUNCTION,
CONNECTION FOR EXTERNAL SENSOR

		PU: 1 pc.
Version	Art. no.	
digital, white	928-900	

5. BLANKE ROOM-CONTROL DEVICE 230, BLACK

SUPPLY VOLTAGE: 230 V
WITH INTEGRATED CLOCK FUNCTION,
CONNECTION FOR EXTERNAL SENSOR

		PU: 1 pc.
Version	Art. no.	
digital, black	929-900	

6. BLANKE ACTUATOR 230 V

THERMAL ACTUATOR A5.
230 V NC, 4.0 MM ACTUATOR TRAVEL, VA 80
THREAD: M30 × 1.5 MM

		PU: 1 pc.
Art. no.		
963-900		



- 1 BASE UNIT 230, 6/10 ZONES
- 2 ROOM-CONTROL DEVICE 230, WHITE
- 3 ROOM-CONTROL DEVICE 230, BLACK
- 4 ROOM-CONTROL DEVICE 230, WHITE with clock and sensor connection
- 5 ROOM-CONTROL DEVICE 230, BLACK with clock and sensor connection
- 6 BLANKE ACTUATOR 230 V





SURFACE HEATING SYSTEMS ELECTRICAL



54 BLANKE
ELOTOP CARBON

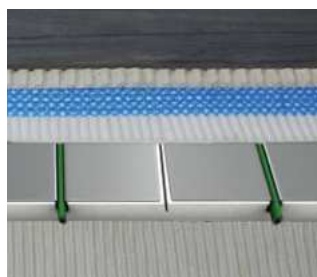

58 BLANKE
ELOTOP 1000

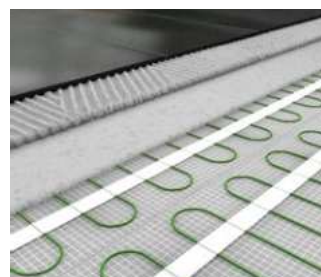

60 BLANKE ELOTOP+

BLANKE ELOTOP - MATRIX

System

BLANKE ELOTOP+

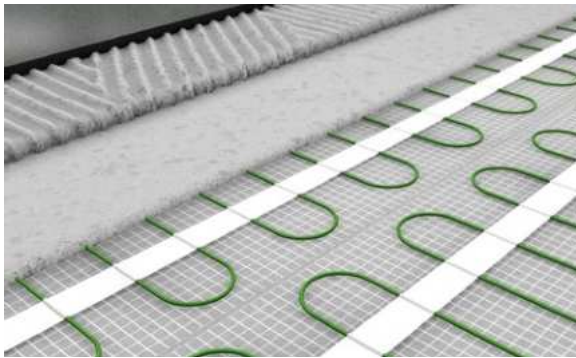

BLANKE ELOTOP 1000

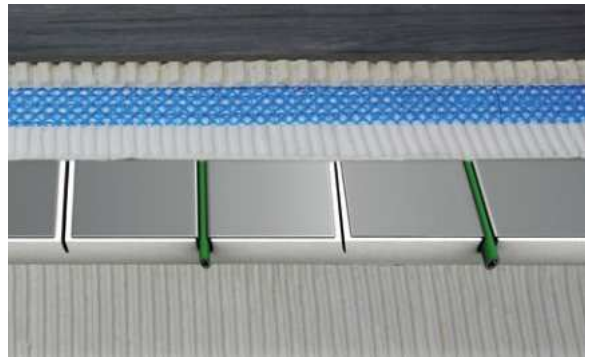

Components

Complete sets incl. digital touch thermostat, protective sleeve for temperature sensor, temperature sensor 2 m long

BLANKE ELOTOP+	Length 2.0 m Length 3.0 m to length 12.0 m
----------------	--

Single mats	no other accessories
-------------	----------------------

BLANKE ELOTOP+	Length 2.0 m Length 3.0 m to length 30.0 m
----------------	--

Digital touch thermostat

Digital touch thermostat WiFi

Grooved panel

Combi-element

Heating tape	50 m 100 m
--------------	---------------

Connection set

BLANKE PERMAT

BLANKE GLUEMAX

Sensor connection set

WiFi Touch room thermostat

4-channel connection controller

Installation height

Heating mat 3.2 mm

System element panels 20 mm without Permat/25 mm with Permat

Substrate

Level and load-bearing, see installation instructions

Level and load-bearing, see installation instructions

Mounting

Heating mat self-adhesive on substrate

Firmly bonded to the existing substrate

Advantages

Fast reacting, thin layer, very light, very suitable for renovations

Very fast reacting, thin layer, very light, minimal moisture

Note

Prefabricated electric underfloor heating system on self-adhesive heating mat, perfect for renovations thanks to its low installation height

Self-regulating heating tape, suitable for all types of floor covering (parquet, laminate, carpet), can be used as a full heating system in efficiency houses, heating tape can be shortened as required

Tech. data

Voltage	230 Volt AC
Electrical power	160 W/m ²
Width heating mat	0.50 m

Voltage	230 Volt AC
Heating tape electrical rating	10 - 25 W/m
Electrical power	70 - 170 W/m ²

BLANKE ELOTOP CARBON (Wall)



Heating mat	2000 × 590 × 0.4 mm
-------------	---------------------

Heating mat contacted on both sides	2200 × 590 × 0.4 mm 3000 × 590 × 0.4 mm
-------------------------------------	--

Crimp connector	6.0 mm ² 2.5 mm ²
-----------------	--

WIFI Touch Thermostat

Sensor connection set floor
(on request for walls)

Power supply unit	300 W 800 W
-------------------	----------------

Twin connecting cable	10 m 2 × 2.5 mm ² 25 m 2 × 6.0 mm ²
-----------------------	--

Switching relay

Heating mat 0.4 mm

Level, load-bearing, if possible with insulation to the substrate, see installation instructions (Prime substrate with BLANKE GROUND)

Firmly bonded to the existing substrate

Low installation height, simple and quick installation, mild radiant heat

Can be used as wall heating and as a full heating system in efficiency houses 40/50. invisible radiant heating with a safety extra-low voltage of 36 V (AC). Can be shortened as required, openings for fittings can be cut out up to a diameter of 7 cm

Voltage	36 V SELV (Safety extra-low voltage)
---------	--------------------------------------

Electrical power	132 W/m = 220 W/m ²
------------------	--------------------------------

BLANKE ELOTOP CARBON (Floor)



Heating mat	1000 × 590 × 0.4 mm
-------------	---------------------

Heating mat contacted on both sides	4500 × 590 × 0.4 mm
-------------------------------------	---------------------

Crimp connector	6.0 mm ² 2.5 mm ²
-----------------	--

WIFI Touch Thermostat

Sensor connection set floor

Power supply unit	300 W 800 W
-------------------	----------------

Twin connecting cable	10 m 2 × 2.5 mm ² 25 m 2 × 6.0 mm ²
-----------------------	--

Switching relay

Heating mat 0.4 mm

Level, load-bearing, if possible with insulation to the substrate, see installation instructions (Prime substrate with BLANKE GROUND)

Firmly bonded to the existing substrate

Low installation height, simple and quick installation, mild radiant heat

Can be used as wall and floor heating and as a full heating system in efficiency houses 40/50. invisible radiant heating with a safety extra-low voltage of 36 V (AC)

Voltage:	36 V SELV (Safety extra-low voltage)
----------	--------------------------------------

Electrical power	66 W/m = 110 W/m ²
------------------	-------------------------------



BLANKE ELOTOP CARBON

Based on 36V (SELV – safety extra-low voltage), BLANKE ELOTOP CARBON is an electric surface heating system for use in walls and floors. Due to its special design, the ultra-thin, diffusion-open, fleece-laminated heating mat with its surface perforations adheres particularly well to the tile adhesive and thus forms a stable connection to the substrate. The system responds swiftly and is ideal for heating floors and walls in bathrooms and shower areas, as well as for protecting masonry in wall areas to reduce moisture as part of mould prevention measures, or as a fully fledged heating system in renovated buildings or newly built low-energy houses (efficiency houses 40 or 50).

BLANKE ELOTOP CARBON – WALL APPLICATION

Important note:

Certified and compliant with standards

In addition to the manufacturer's tests, the BLANKE ELOTOP CARBON system was tested and certified by the independent certification body TÜV Rheinland. It goes without saying that the entire system consisting of heating mat, power supply units and thermostats complies with all legal requirements including the those of the Ecodesign Directive.

Bonding with a commercially available tile adhesive of the quality acc. to DIN 12004 and 12002 C2 and S1 to the substrate.

1. BLANKE ELOTOP CARBON 2.0

HEATING MAT 36 V (AC) – WALL HEATING
ELECTRICAL POWER: 132 W/m; 220 W/m²

2000 × 590 × 0.4 mm = 1.20 m² heating surface
contacted on one side

PU: 1 pc.

Length in m	Art. no.
2.00 m	918-900-220200

1. BLANKE ELOTOP CARBON 2.2

HEATING MAT 36 V (AC) – WALL HEATING
ELECTRICAL POWER: 132 W/m; 220 W/m²

2200 × 590 × 0.4 mm = 1.32 m² heating surface
contacted on both sides

PU: 1 pc.

Length in m	Art. no.
2.20 m	918-900-220220

1. BLANKE ELOTOP CARBON 3.0

HEATING MAT 36 V (AC) – WALL HEATING
ELECTRICAL POWER: 132 W/m; 220 W/m²

3000 × 590 × 0.4 mm = 1.80 m² heating surface
contacted on both sides

PU: 1 pc.

Length in m	Art. no.
3.00 m	918-900-220300



BLANKE ELOTOP CARBON – FLOOR APPLICATION

1. BLANKE ELOTOP CARBON 1.0

HEATING MAT 36 V (AC) – FLOOR HEATING
ELECTRICAL POWER: 66 W/m; 110 W/m²

1000 × 590 × 0.4 mm = 0.60 m² heating surface
contacted on one side

PU: 1 pc.

Length in m	Art. no.
1.0 m	918-900-110100

1. BLANKE ELOTOP CARBON 4.5

HEATING MAT 36 V (AC) – FLOOR HEATING
ELECTRICAL POWER: 66 W/m; 110 W/m²

4500 × 590 × 0.4 mm = 2.70 m² heating surface
contacted on both sides

PU: 1 pc.

Length in m	Art. no.
4.5 m	918-900-110450

TECHNICAL DATA

Safety extra-low voltage SELV:	36 V (AC)
Nominal limit temperature:	70°C
Minimum installation temperature:	5°C
Minimum bending radius of the heating mat:	R = 10 mm
Material:	PET film with carbon fibres and fillers
Heating mat connecting cable:	2.5 mm ²
Secondary cable between power supply unit and heating mat:	2.5 mm ² max. length 10 m 6.0 mm ² max. length 25 m
Max. heat transfer resistance for flooring:	0.15 m ² K/W

BLANKE ELOTOP CARBON COMPLETE SET

BLANKE ELOTOP CARBON - 1.3 m² SET
WALL COMPLETE SET 1

PU: 1 pc.

Art. no.

924-900-SET-1



BLANKE ELOTOP CARBON - 3.6 m² SET
WALL COMPLETE SET 2

PU: 1 pc.

Art. no.

924-900-SET-2



Important note:

- The **BLANKE ELOTOP CARBON WALL complete set 1** consists of:
- > 1 Heating mat 2200×590×0.4 mm (L×W×H) (1.3 m²), 36 V, electrical power 132 W/m (electrical power 220 W/m²) contacted on both sides
 - > Power supply unit 300 W with connector
 - > 1 WIFI Touch Thermostat and separately packaged switching relay
 - > 1 × 10 m Twin connecting cable 2 × 2.5 mm²
 - > 1 bag CRIMP 2.5 mm² (5 pcs.)

- The **BLANKE ELOTOP CARBON WALL complete set 2** consists of:
- > 2 Heating mats, 3000×590×0.4 mm (L×W×H) (3.6 m²), 36 V, electrical power 132 W/m (electrical power 220 W/m²) contacted on both sides
 - > Power supply unit 800 W
 - > 1 WIFI Touch Thermostat
 - > 2 × 10 m Twin connecting cable 2 × 2.5mm²
 - > 2 bags CRIMP 2.5 mm² (5 pcs.)

BLANKE ELOTOP CARBON COMPONENTS

2. BLANKE ELOTOP CARBON

TWIN CONNECTING CABLE

PU: 1 pc.

Cross-section	Length	Art. no.
2 × 2.5 mm ²	10 m	919-900-2510
2 × 6.0 mm ²	25 m	919-900-6025

3. BLANKE ELOTOP CARBON

CRIMP (CRIMP CONNECTOR)

PU: 1 bag

Cross-section	Amount	Art. no.
2.5 mm ²	5 pcs.	920-900-25
6.0 mm ²	20 pcs.	920-900-60

Important note:

Individually customisable - horizontal cuts and cut-outs up to 5 pcs. / 1m possible

4. BLANKE ELOTOP CARBON 300 W

POWER SUPPLY UNIT 230 V PRIMARY/36 V (AC) SECONDARY

PU: 1 pc.

Art. no.

921-900-300

5. BLANKE ELOTOP CARBON 800 W

POWER SUPPLY UNIT 230 V PRIMARY/36 V (AC) SECONDARY

PU: 1 pc.

Art. no.

921-900-800

Important note:

The copper strip of the BLANKE ELOTOP CARBON must under no circumstances be damaged when attaching BLANKE HASTA or BLANKE HOOK or through other possible drill holes!

6. BLANKE ELOTOP CARBON

SWITCHING RELAY FOR WIFI THERMOSTAT (726-900)
ONLY REQUIRED FOR 300 W POWER SUPPLY UNIT!

PU: 1 pc.

Art. no.

922-900

7. BLANKE ELOTOP CARBON

WIFI TOUCH THERMOSTAT
INCLUDING TEMPERATURE SENSOR

PU: 1 pc.

Art. no.

726-900

8. BLANKE ELOTOP CARBON

SENSOR CONNECTION SET FOR FLOOR HEATING

PU: 1 pc.

Art. no.

725-900

BLANKE ELOTOP CARBON COMPONENTS

- 1 HEATING MAT
- 2 TWIN CONNECTING CABLE
- 3 CRIMP 2.5/6.0 mm² [CRIMP CONNECTOR]
- 4 POWER SUPPLY UNIT 300 W
- 5 POWER SUPPLY UNIT 800 W
- 6 SWITCHING RELAY for WIFI TOUCH THERMOSTAT (only required for 300 W POWER SUPPLY UNIT)
- 7 WIFI TOUCH THERMOSTAT including temperature sensor
- 8 SENSOR CONNECTION SET for floor heating



BLANKE ELOTOP CARBON

The invisible bathroom radiator



Anyone who has already experienced it will no longer want to do without it: BLANKE ELOTOP CARBON offers a unique radiant heat experience in the shower. By combining the innovative electric heating foil in the wall area with a towel rail, you get an invisible alternative to the classic bathroom radiator. Enjoy complete freedom for your interior design! Your advantages at a glance:

ADVANTAGES AT A GLANCE

- > **Puristic Look**
Design your bathroom regardless of the heating pipes! The only 0.4 mm thin BLANKE ELOTOP CARBON can be installed anywhere, be it on the wall or the floor.
- > **Private spa oasis**
A pre-warmed bathrobe, a warm towel or a cozy heated bench thanks to the pleasant radiant heat - all of this offers BLANKE ELOTOP CARBON in your home!
- > **Convincingly fast and flexible**
The carbon heating foil, which can be subsequently drilled, is simply placed in the tile adhesive and its perforations form a secure connection with the substrate.
- > **Heat at the touch of a button**
The system works as a fast-acting, on-demand heating system that can be operated and controlled room by room. This quickly gives you pleasant radiant heat.

BLANKE HASTA

The 60 cm-long BLANKE HASTA towel rail is available in chrome and matt black. It is perfectly suitable in combination with the BLANKE ELOTOP CARBON - creating an invisible, electric bathroom radiator. Install the BLANKE HASTA at any height on the wall and conveniently hang up your towel or bathrobe to dry them quickly. Practical: The concealed fastening and screws are included.



BLANKE HASTA

ZINC STAINLESS STEEL, CHROME-PLATED

Towel rail for an invisible radiator PU: 1 pc.

Length	Art. no.
60.0	200-9840-060

BLANKE HASTA

ZINC STAINLESS STEEL, MATT BLACK

Towel rail for an invisible radiator PU: 1 pc.

Length	Art. no.
60.0	200-9856-060

BLANKE HOOK

The BLANKE HOOK wall hook is ideal for practical hanging up towels in the bathroom. The purist design is available in chrome and matt black and fits in with any furnishing style. Practical: The concealed fastening and screws are included. The BLANKE HOOK can be perfectly installed together with the BLANKE ELOTOP CARBON wall radiator. This gives you an invisible bathroom radiator for quickly drying your towels.



BLANKE HOOK

ZINC, CHROME-PLATED

Hooks for invisible radiators PU: 1 pc.

Art. no.
201-940

BLANKE HOOK

ZINC, MATT BLACK

Hooks for invisible radiators PU: 1 pc.

Art. no.
201-966



Expert tip:

Install the BLANKE HASTA and BLANKE HOOK in combination with the BLANKE ELOTOP CARBON as an invisible radiator.

Important note:

The copper strip of the BLANKE ELOTOP CARBON must under no circumstances be damaged when attaching BLANKE HASTA or BLANKE HOOK or through other possible drill holes!

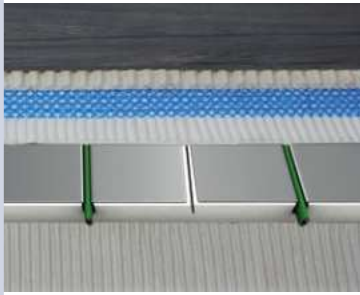

Expert tip:

The BLANKE ELOTOP 1000 is a fully-fledged heating system. It is suitable as an underfloor heating system for buildings with efficiency house standard 50/40.



Important note:

The BLANKE ELOTOP 1000 COMBI-ELEMENT consists of 4 elements with bends and 2 elements that serve as edge compensating panels.

The connection controller is required when 3 - 4 individual rooms are to be switched simultaneously to prevent overloading the fuse.

Room size up to 9 m², direct connection to room thermostat; max. heating tape length 60 m; nominal meter box fuse rating 16 A [C characteristic].

BLANKE ELOTOP 1000

The BLANKE ELOTOP 1000 electric floor heating system is an alternative to water-based under-floor heating systems. The ELOTOP 1000 is a dry-lining system, ideally suited for renovations. The BLANKE HEATING TAPE is easily inserted into the BLANKE ELOTOP 1000 system panel with aluminium baffles and when in operation, helps to achieve fast, even and efficient floor heating. The heating tape is self-regulating and reliably limited to the maximum temperature. The system also offers high compressive stability thanks to the BLANKE PERMAT decoupling mat, which is bonded using BLANKE GLUEMAX.

BLANKE ELOTOP 1000 COMPLETE SET

BLANKE ELOTOP 1000

COMPLETE SET FOR CERAMIC

PU: 1 pc.

Art. no.

718-900-1000

BLANKE ELOTOP 1000 COMPONENTS

1. BLANKE ELOTOP 1000

GROOVED PANEL

1200 × 750 mm h = 20 mm (0.90 m²)

Thermal conductivity group:

WLS 035

PU: 1 pc.

Art. no.

719-900

2. BLANKE ELOTOP 1000

COMBI-ELEMENT

1200 × 750 mm h = 20 mm

Thermal conductivity group:

WLS 035

PU: 1 pc.

Art. no.

720-900

3. BLANKE ELOTOP 1000

HEATING TAPE

PU: 1 roll

Im

Art. no.

50

721-900-050

100

721-900-100

4. BLANKE ELOTOP 1000

CONNECTION SET

PU: 1 pc.

Art. no.

723-900

5. BLANKE ELOTOP 1000

TERMINATING SET

PU: 1 pc.

Art. no.

722-900

6. BLANKE RDS 5/50

EDGE INSULATION STRIP WITH SELF-ADHESIVE BASE

Dimensions: 5 × 50 mm

PU: 1 roll

Im

Art. no.

25

685-900

7. BLANKE GLUEMAX

1 bag =

PU: 1 bag

Version

Art. no.

5 kg

603-900-5

18 kg

603-900

8. BLANKE PERMAT

30 mats/carton

Dimensions: 97 × 62 cm

PU: 1 carton

Art. no.

Art. no.

1 carton = 18 m²

527-904

1 pallet (11 × cartons) = 198 m²

527-904

1 pallet (334 × individual panels) = 200 m²

527-904-PAL

ACCESSORIES FOR BLANKE ELOTOP 1000

9. BLANKE ELOTOP 1000

SENSOR CONNECTION SET

PU: 1 pc.

Art. no.

725-900

10. BLANKE ELOTOP 1000

WIFI TOUCH THERMOSTAT

PU: 1 pc.

Art. no.

726-900

11. BLANKE ELOTOP 1000

4-CHANNEL CONNECTION CONTROLLER

PU: 1 pc.

Art. no.

729-900

12. BLANKE ELOTOP 1000

REPAIR SET

PU: 1 pc.

Art. no.

724-900

SYSTEM COMPONENTS RECOMMENDATION: FLOOR CONSTRUCTION

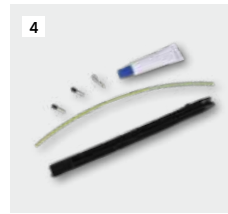

- 1 ELOTOP 1000 GROOVED PANEL
- 2 ELOTOP 1000 COMBI-ELEMENT
- 3 ELOTOP 1000 HEATING TAPE
- 4 ELOTOP 1000 CONNECTION SET
- 5 TERMINATING SET
- 6 BLANKE RDS 5/50
- 7 BLANKE GLUEMAX
- 8 BLANKE PERMAT



ADDITIONAL PRODUCTS



- 9 SENSOR CONNECTION SET
- 10 WIFI TOUCH THERMOSTAT
- 11 CONNECTION CONTROLLER
- 12 REPAIR SET

Important note:

If a control system is not available, the SENSOR CONNECTION SET and WIFI TOUCH ROOM THERMOSTAT must also be requested.

Important note:

We recommend suitable tools for installing BLANKE surface heating systems easily and reliably.

Product details for the ELOTOP tools can be found from page 68.

TECHNICAL DATA

Voltage:	230 V (AC)	Nominal temp. limit:	max. surrounding temperature 65°C (min. installation temperature 0°C)
Heating tape output:	10 - 25 W/m	Protective measure:	meter box fuse rating 20 A [C characteristic]
Electric power:	70 - 170 W/m ²	Fusing:	30 mA Earth leakage circuit breaker
Size of pipe:	13 × 5 mm	Connection cable:	40 W/m electric power (270 W/m ²) (max. power)
Bending radius:	25 mm (min. bending radius)	Test voltage:	insulation resistance measuring mind. 500 V
		Thermal conductivity levels:	(WLS) 035 (0.035 W/(mK))
		Fire behavior:	E according to DIN EN 13501-1 norm (without top covering)

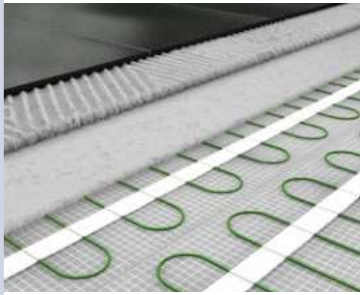

BLANKE ELOTOP+

The latest generation of electric underfloor heating. BLANKE ELOTOP+ is suitable for use as the main heating system as well as a supplementary heating to provide perfect temperature control of all tile and natural stone coverings - including in wet areas such as in floor level showers. Thanks to the integrated temperature sensor in each individual room it is easily possible to regulate the desired temperature to suit your needs. When renovating or refurbishing there is no need to extend the central heating system at huge cost, because it is possible to install the BLANKE ELOTOP+ retrospectively and without any difficulty during renovation work.



BLANKE ELOTOP+ 160 W/m² COMPLETE SET (DIGITAL TOUCH THERMOSTAT WIFI; PROTECTIVE SLEEVE FOR THE TEMPERATURE SENSOR, LENGTH 2 m; TEMPERATURE SENSOR, LENGTH 2 m)

Width: 0.5 m PU: 1 set

m ²	l in m	Art. no.
1.00	2.0	230-900-0500200
1.50	3.0	230-900-0500300
2.00	4.0	230-900-0500400
2.50	5.0	230-900-0500500
3.00	6.0	230-900-0500600
4.00	8.0	230-900-0500800
5.00	10.0	230-900-0501000
6.00	12.0	230-900-0501200



Important note:

BLANKE ELOTOP+ is VDE approved - the guarantee for a safe and high-quality product.

Important note:

The lengths of the heating mats have tolerances of -5% to +10% in relation to the specified lengths.

BLANKE ELOTOP+ 160 W/m² INDIVIDUAL MATS INCLUDING PROTECTIVE SLEEVE

Width: 0.5 m PU: 1 roll

m ²	l in m	Art. no.
1.00	2.0	225-900-0500200
1.50	3.0	225-900-0500300
2.00	4.0	225-900-0500400
2.50	5.0	225-900-0500500
3.00	6.0	225-900-0500600
4.00	8.0	225-900-0500800
5.00	10.0	225-900-0501000
6.00	12.0	225-900-0501200
7.00	14.0	225-900-0501400
8.00	16.0	225-900-0501600
9.00	18.0	225-900-0501800
10.00	20.0	225-900-0502000
12.00	24.0	225-900-0502400
15.00	30.0	225-900-0503000

ACCESSORIES

BLANKE ELOTOP+ REPAIR SET

PU: 1 set

Art. no.	227-900
----------	---------

BLANKE ELOTOP+ DIGITAL TOUCH THERMOSTAT*

PU: 1 pc.

Art. no.	220-900
----------	---------

BLANKE ELOTOP+ DIGITAL TOUCH THERMOSTAT WIFI*

PU: 1 pc.

Art. no.	224-900
----------	---------



*including temperature sensor

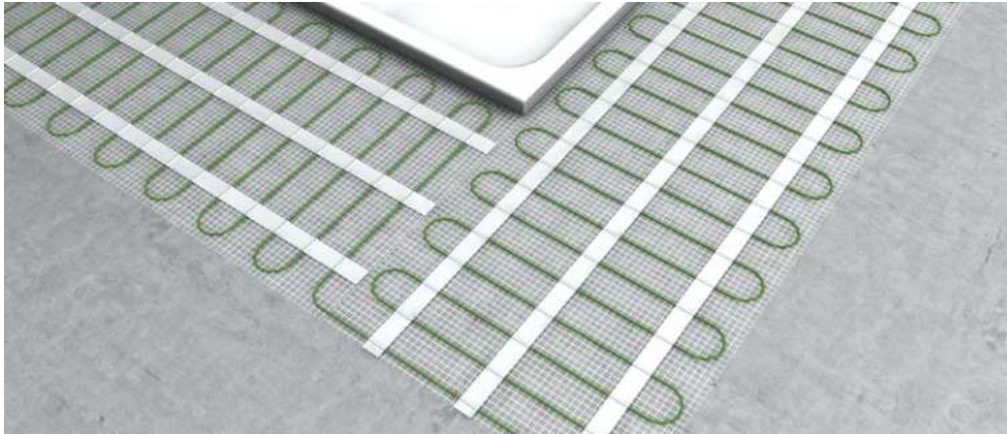

■ BLANKE ELOTOP+ LAID 90° AROUND A CORNER

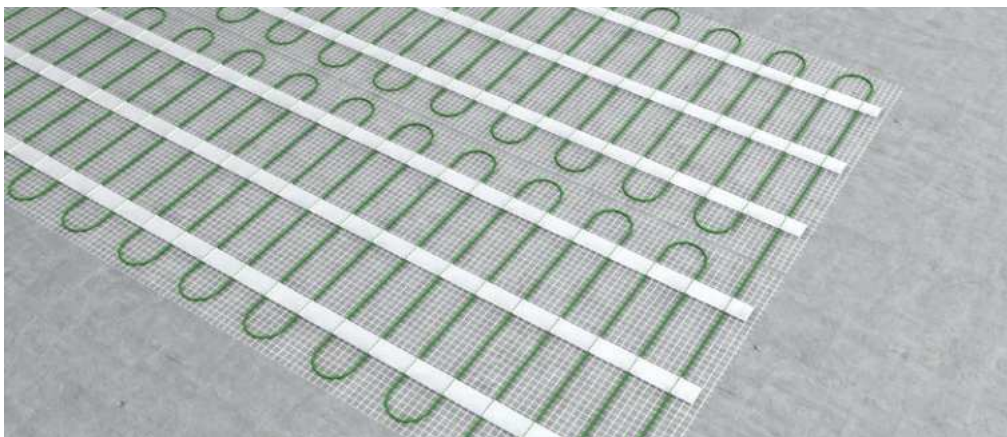

■ BLANKE ELOTOP+ LAID TURNED BACK BY 180°

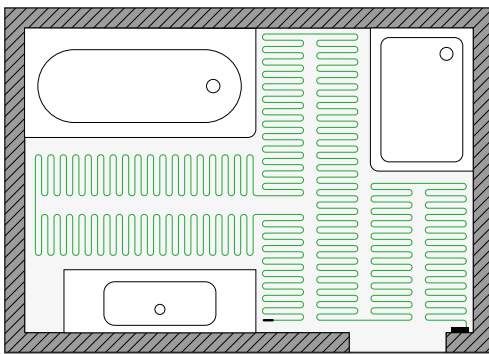

■ BLANKE ELOTOP+ LAID OVER THE WHOLE SURFACE

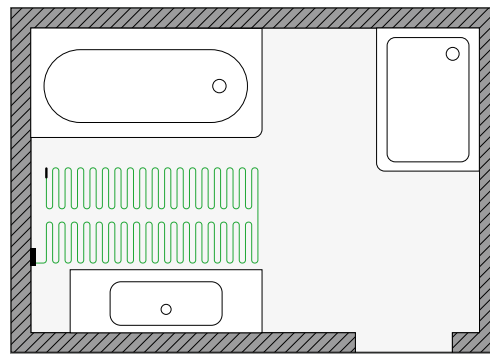

■ BLANKE ELOTOP+ LAID IN PART OF SURFACE AREA

Perceptible warmth in the briefest of time

BLANKE ELOTOP+ produces particularly pleasant warmth, perceptible in the briefest of time.

Individually adaptable to any floor plan

It is possible to lay BLANKE ELOTOP+ over the whole or part of a surface to suit your needs in each individual room.

Perfect for renovations

Thanks to the low installation height BLANKE ELOTOP+ is ideal for all types of refurbishments.

No electromagnetic pollution, suitable for allergy sufferers

Rooms are heated gently from bottom to top, so no allergens are whirled up.

TECHNICAL DATA

Voltage:	230 V (AC)	Nominal temp. limit:	+80° C
Output, mat:	160 W/m ²	Protective measure:	RCD: 30 mA
Width of mat:	0.50 m	Fusing:	13 A (B characteristic)
Size of pipe:	ca. 3.2 mm	Connection cable:	ca. 3.0 m
Bending radius:	mind. 30 mm	Test voltage:	500 - 1.000 V
Load:	max. 16 A (3200 W) recommended 13 A (2990 W)	Backing material:	Glass fibre mesh, self-adhesive

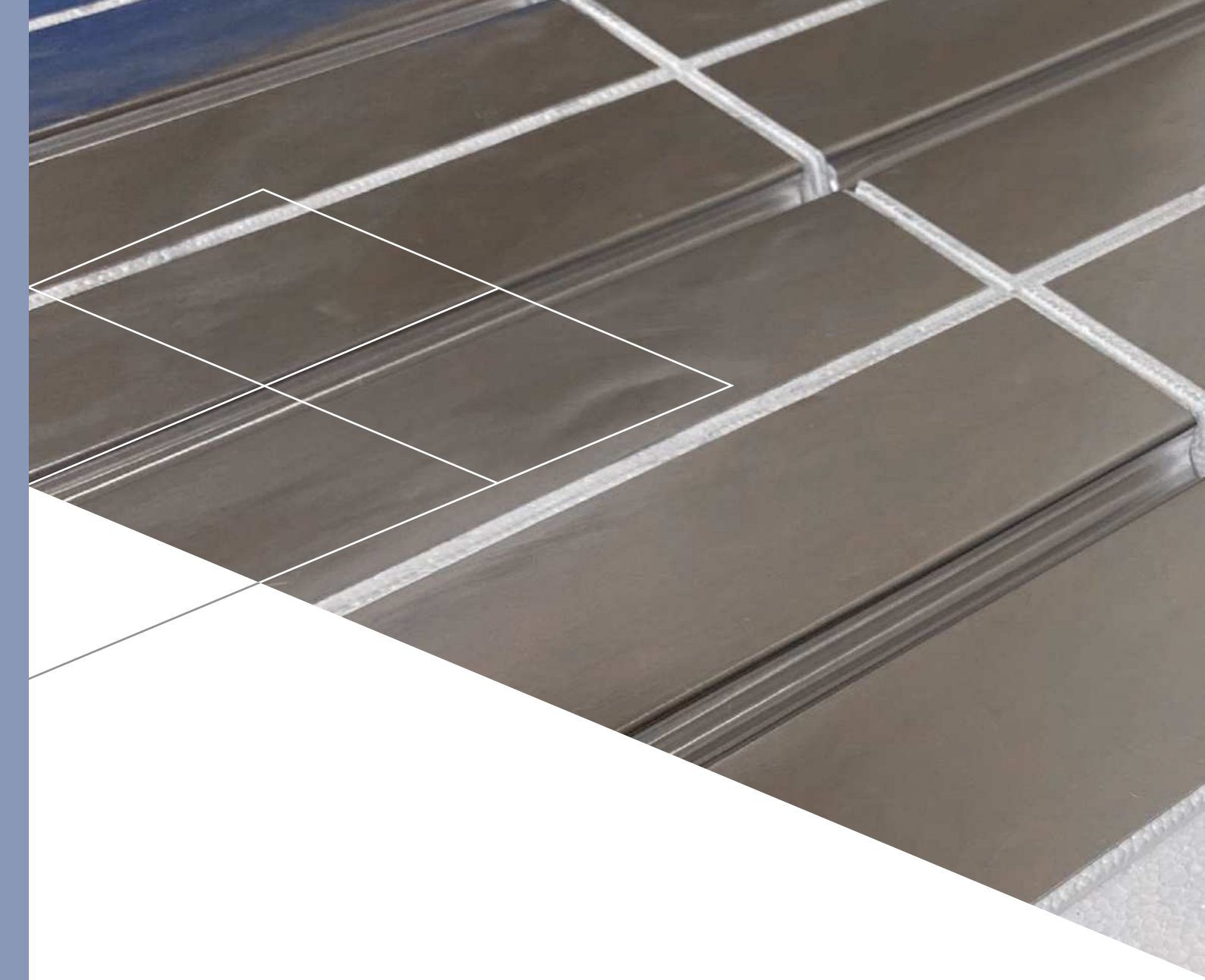

SUPPLEMENTAL PRODUCTS

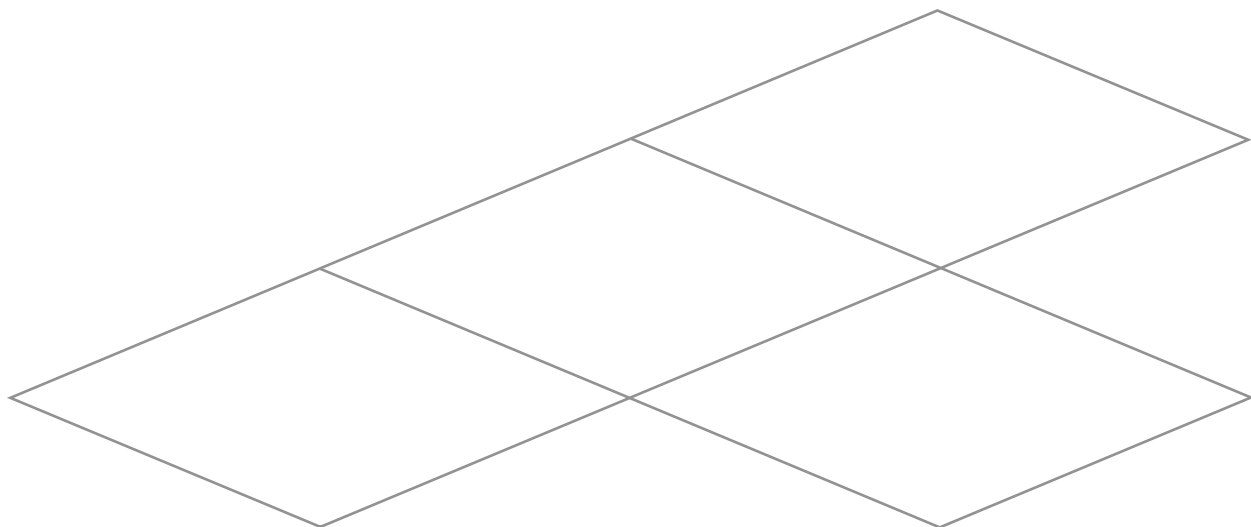



64 BLANKE PERMAT



67 BLANKE FILLOTHERM

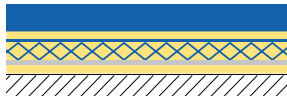

BLANKE PERMAT

BLANKE PERMAT reliably protects tiles and natural stone against cracking and compensates for stresses in the substrate. The universal underlay for industrial and private applications can be used as reinforcement on all substrates. Including new and old screed as well as wooden substrates. BLANKE PERMAT is suitable for ceramic coverings of any size and especially for large-format tiles. Thanks to the glass fibre mesh and multilayer structure the system boasts high adhesive bonding values as well as resistance to bending, tensile and compressive loads. As deformations from the substrate are not transferred to the covering, the decoupling mat allows floor coverings to be laid sooner. It also complements a variety of surface heating and cooling systems, as well as the BLANKE PERMATFLOOR screed-free floor construction.

BLANKE PERMAT

30 mats/carton, Panel: 0.60m²
Dimensions: 97 × 62 cm

PU: 1 carton

Art. no.

1 carton = 18 m²

527-904

1 pallet (11 × carton) = 198 m²

527-904

1 pallet (334 × individual panels) = 200 m²

527-904-PAL

Important note:

Including test report

tBU Greven (test institute)

Suitable for:

- > Dry screeds
- > Old screed/old substrates with cracks
- > All types of wood floors
- > On top of old tiles with cracks
- > New screed, to prevent cupping
- > Underfloor heating

Security since 2004:

The innovative reinforcing BLANKE PERMAT underlay & decoupling mat have been offering reliability for tiles since 2004.



Point load

15.96 kN

Eliminates broken tiles due to excellent protection against point loads

Bond strength

0.93 N/mm²

Unique strength, corresponds to tile adhesive standard

Traffic load

7.5 kN/m²

Clear strengthening of floor construction

Material thickness

3.3 mm

Ideal for renovations thanks to very low installation height

Diffusion capability

100%

Guarantees adhesive dries reliably

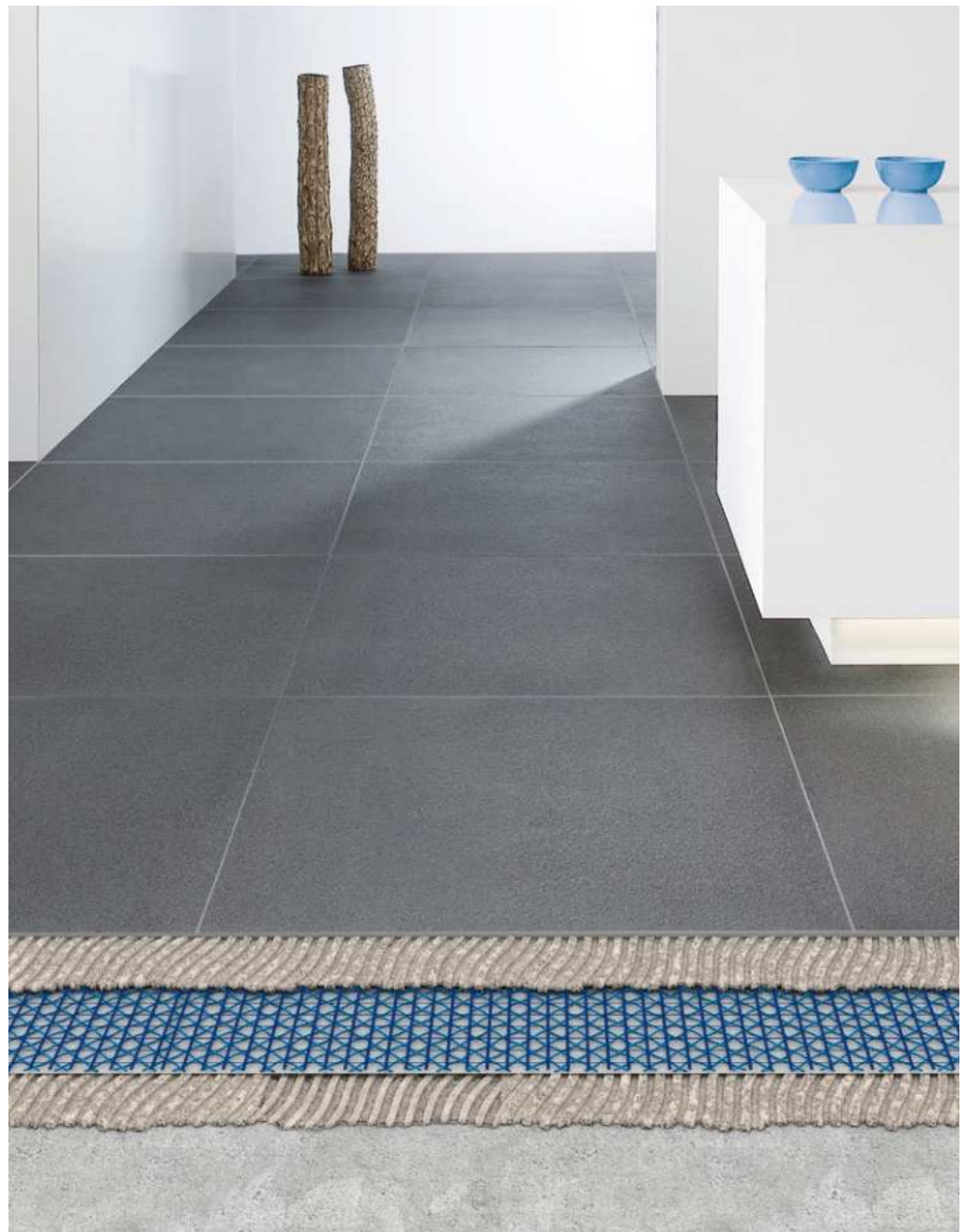

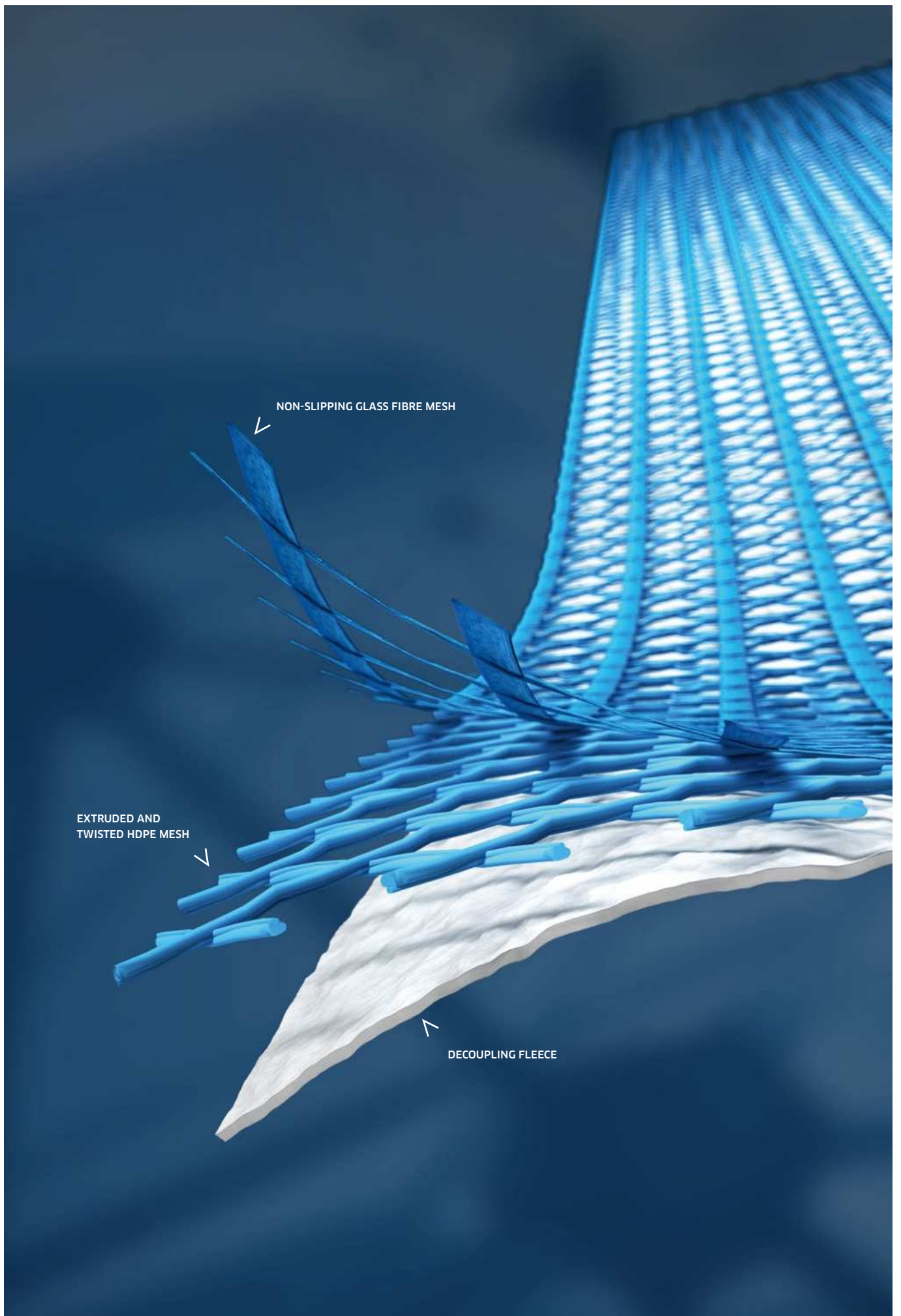

BLANKE GROUND

BLANKE GROUND is a solvent-free primer used for preparing substrates before sealing with the self-adhesive BLANKE DISK waterproofing system. Once the primer is dry, sealing work can be started. The primer can also be used as preparation for spatula work or thin-bed tile laying. BLANKE GROUND can be used for BLANKE DISK and for all system solutions from Blanke (DIBA, PERMAT, TRIBOARD etc.).

BLANKE GROUND

ADHESIVE AND PRIMER DISPERSION

	PU: 1 bucket
<u>kg</u>	<u>Art. no.</u>
5.0	289-900-5000

BLANKE GLUEMAX

BLANKE GLUEMAX is a fast-setting powder dispersion adhesive that is especially suitable for bonding to aluminium surfaces. It is used as a system adhesive for applying the BLANKE PERMAT to BLANKE's dry construction systems. This includes the water-based and electric surface heating and cooling systems as well as the BLANKE PERMATFLOOR floor system. You can plan on using 2.5 kg per square metre (8 mm serration).

I Advantages:

- > Easy working
- > System product for
BLANKE PERMATOP
BLANKE ELOTOP 1000
BLANKE PERMATFLOOR
- > Very economical in use
- > Highly flexible
- > Fast curing

BLANKE GLUEMAX

1 bag = 5 kg	PU: 1 bag
<u>Art. no.</u>	<u>Art. no.</u>
603-900-5	603-900

BLANKE GLUEMAX

1 bag = 18 kg	PU: 1 bag
<u>Art. no.</u>	<u>Art. no.</u>
603-900	603-900

BLANKE GLUEMAX

1 pallet = 42 × 18 kg	PU: 1 pallet
<u>Art. no.</u>	<u>Art. no.</u>
603-900	603-900

BLANKE SF FILLER

BLANKE SF FILLER is a low-stress, self-levelling energy distribution layer for the modular surface heating and cooling system BLANKE PERMATOP SF. The low-stress product is used for embedding and for fully enclosing the BLANKE SF KLETT-TEC heating and cooling conductors on the self-adhesive fibre fabric mat BLANKE SF BASE, which is part of the system. BLANKE SF FILLER enables you to create a level surface, which ensures high-efficiency heat distribution. The energy distribution layer can also be used to prepare and create level substrates before laying BLANKE PERMATOP, BLANKE PERMATFLOOR, BLANKE PERMAT, BLANKE TRIBOARD or tiles.

BLANKE SF FILLER

ENERGY DISTRIBUTION LAYER

1 bag = 25 kg	PU: 1 bag
<u>Art. no.</u>	<u>Art. no.</u>
604-900	604-900

BLANKE FILLOTHERM

BLANKE FILLOTHERM is a fast-curing energy distribution layer for the BLANKE PERMATOP BF+, BFC and SF 14 underfloor heating systems. The low-shrinkage product encloses the heating pipe and ensures optimum, even heat distribution. Thanks to the special geometry of the BLANKE PERMATOP BF+ BASE and BFC BASE studded structure, a thin 8 mm covering suffices to create a self-supporting energy distribution layer in combination with the BLANKE PERMAT underlayment and decoupling mat.

BLANKE FILLOTHERM

FAST-CURING ENERGY DISTRIBUTION LAYER
FOR BLANKE PERMATOP BF+, BFC AND SF 14

1 bag = 25 kg PU: 1 bag

Art. no.

674-900



Advantages:

- > Fast-curing
- > Low-tension
- > Self-spreading
- > Early readiness for covering
- > Minimum shrinkage
- > Can be applied manually or mechanically

BLANKE GLASS FIBRE MESH P 100

BLANKE GLASS FIBRE MESH P 100 is a very non-slipping and alkali-resistant material. Ideal for use as an anchoring fabric for wooden board substrates which require subsequent levelling using a suitable levelling compound.

BLANKE GLASS FIBRE MESH P 100

Length: 100.0 m PU: 1 roll

w=m Art. no.

1.0 527-904-02

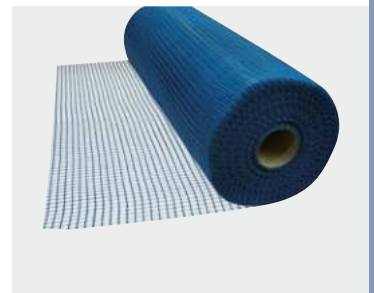

BLANKE GLASS FIBRE MESH 15 SK

BLANKE GLASS FIBRE MESH 15 SK is a self-adhesive mesh for use as a crack-bridging and anchoring layer for the BLANKE BALCONY BP anchoring leg.

BLANKE GLASS FIBRE MESH 15 SK

Length: 50.0 m PU: 1 roll

w=cm Art. no.

15.0 599-900



TOOLS FOR SURFACE HEATING SYSTEMS FROM BLANKE

BLANKE EPS GROOVE CUTTER

The 230V electric groove cutter with depth stop is perfect for easy cutting of connection lines or pipe openings when laying BLANKE PERMATOP 1000/3000 UND WALL.

BLANKE EPS GROOVE CUTTER

PU: 1 pc.

Art. no.

728-900

BLANKE REPLACEMENT HEAD

Easily-replaced head for the EPS groove cutter.

BLANKE REPLACEMENT HEAD

PU: 1 pc.

Art. no.

730-900

BLANKE ELOTOP 1000 GROOVE CUTTING TOOL U-CONTOUR

Specific head, U-shaped to create additional grooves for the ELOTOP 1000 heating wire.

BLANKE ELOTOP 1000 GROOVE CUTTING TOOL U-CONTOUR

PU: 1 pc.

Art. no.

732-900

BLANKE ELOTOP 1000 ADAPTER FOR GROOVE CUTTING TOOL HEAD

Easily changeable adapter for the EPS groove cutting tool for U shape cutting tool head

BLANKE ELOTOP 1000 ADAPTER FOR GROOVE CUTTING TOOL HEAD

PU: 1 pc.

Art. no.

733-900

BLANKE ELOTOP 1000 CUTTING TOOL

Special cutting tool for straight cuts in the EPS System panel.

BLANKE ELOTOP 1000 CUTTING TOOL

PU: 1 pc.

Art. no.

735-900



BLANKE PIPE SHEARS

High-quality and practical pipe shears for clean, fast, and burr-free cutting of composite metal piping with a diameter of 14–35 mm.

BLANKE PIPE SHEARS

PU: 1 pc.

Art. no.

734-900



BLANKE CALIBRATION PIN

BLANKE CALIBRATION PIN for composite metal piping. If the pipe contour is deformed, the tool is used to restore the circular geometry of the pipe for the connection.

BLANKE CALIBRATION PIN

PU: 1 pc.

Art. no.

738-900



BLANKE UNCOILER

The BLANKE UNCOILER facilitates laying the piping for surface heating and cooling systems from Blanke Systems. Solid version with smooth swivel joint.

BLANKE UNCOILER

PU: 1 pc.

Art. no.

965-900



GLOSSARY

A			
ACTUATOR		46, 48	
ADAPTER FITTING		42	
B			
BALANCING VALVE		40	
BASE UNIT SMART HOME LIFE		46	
BASE UNIT 230		48	
BENDS		30, 32, 36	
C			
CALIBRATION PIN		69	
CONNECTION ELEMENT		37	
CONNECTION SET ELBOW		40	
CONNECTION SET STRAIGHT		40	
CONTROL 230		48	
COMPRESSION CONNECTOR		28	
COMPRESSION FITTING		26, 28, 36	
COUPLING		26, 37	
D			
DESIGN RETURN TEMPERATURE LIMITER VALVE		42	
DOOR ELEMENT		37	
E			
EDGE INSULATION STRIP		28, 36	
ELBOW ADAPTOR		28	
ELOTOP CARBON		54	
ELOTOP+		60	
ELOTOP 1000		58	
ELOTOP 1000 ADAPTER FOR GROOVE CUTTING TOOL HEAD		68	
ELOTOP 1000 GROOVE CUTTING TOOL U-CONTOUR		68	
ELOTOP 1000 CUTTING TOOL		69	
EPS GROOVE CUTTER		68	
F			
FILLOTHERM		67	
FIXED-VALUE CONTROL STATION		40	
FLATBASE		36	
G			
GATEWAY SMART HOME LIFE		46	
GLASS FIBRE MESH P 100		67	
GLASS FIBRE MESH 15 SK		67	
GLUEMAX		66	
GROUND		66	
H			
HASTA		57	
HEATING CIRCUIT MANIFOLD VARIO		40	
HEATING CIRCUIT MANIFOLD VARIO EXTENSION SET		40	
HOOK		57	
M			
MANIFOLD CABINET		43	
MANIFOLD SHUT-OFF VALVE		40	
MIKRO-LBA		42	
MIXING UNIT		42	
P			
PERMAT		28, 37, 64	
PERMATOP BF		34	
PERMATOP BF+		34	
PERMATOP BFC		34	
PERMATOP ECO		22	
PERMATOP NATURE		24	
PERMATOP SF		30	
PERMATOP SF 14		32	
PERMATOP WALL		26	
PERMATOP WOOD		20	
PERMATOP 1000		16	
PERMATOP 3000		18	
PIPE		36	
PIPE CLIPS		36	
PIPE SHEARS		69	

R

REDUCER	40
REPLACEMENT HEAD	68
RETURN FLOW TEMPERATURE LIMITER VALVE	42
ROOM-CONTROL DEVICE SMART HOME LIFE	46
ROOM-CONTROL DEVICE 230	48

S

SEPARATOR	40
SF BASE	30, 32
SF FILLER	30, 66
SF COMPRESSION FITTING	30, 32
SF KLETT-TEC	30
SF 14 KLETT-TEC	32
SK TAPE	36
SMART HOME LIFE	46
STRAIGHT ADAPTER	28

T

THERMAL INSULATION SHELLS	42
---------------------------	----

U

UNCOILER	69
----------	----

Y

Y-JUNCTION CONNECTOR	42
----------------------	----

NOTES

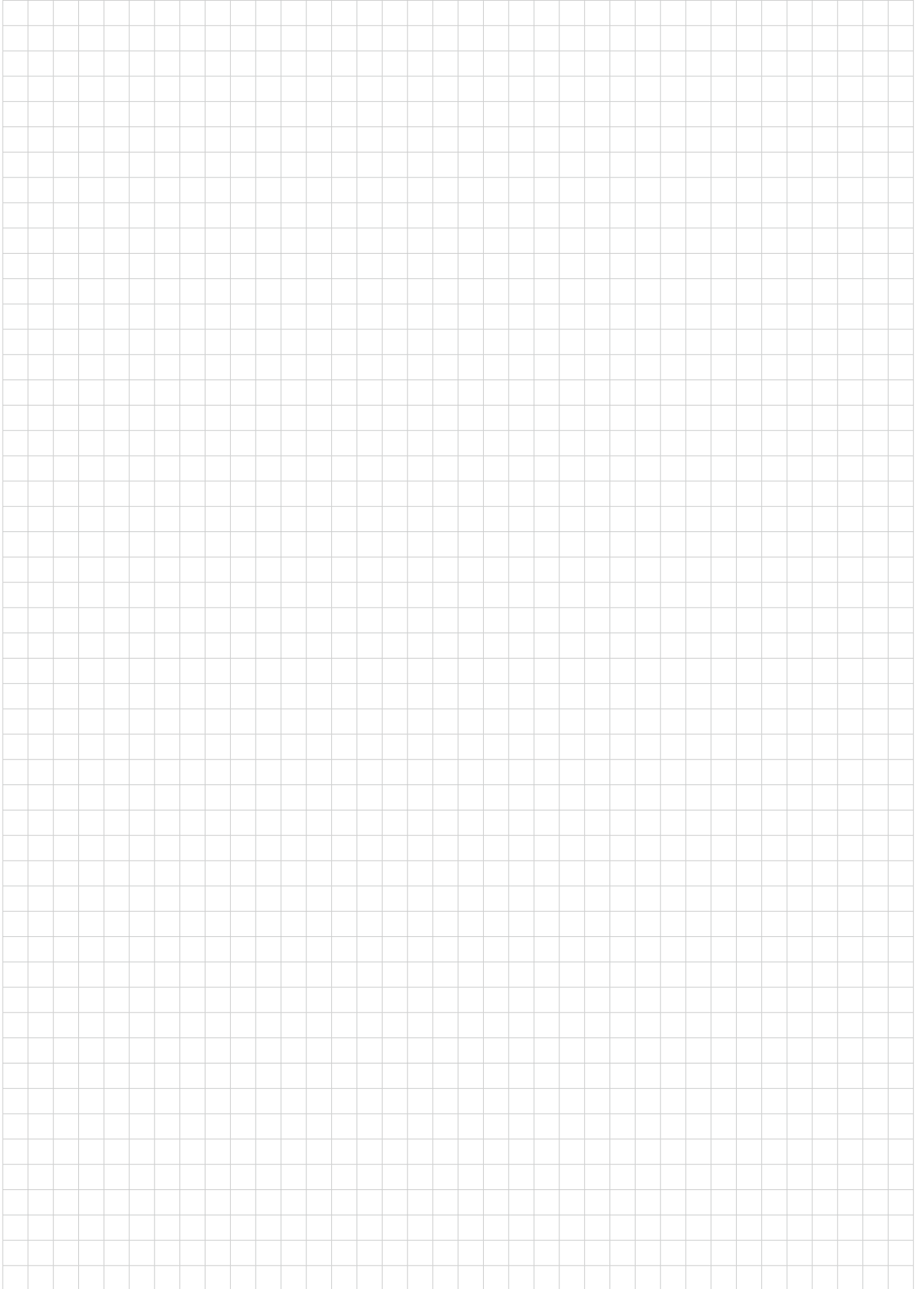

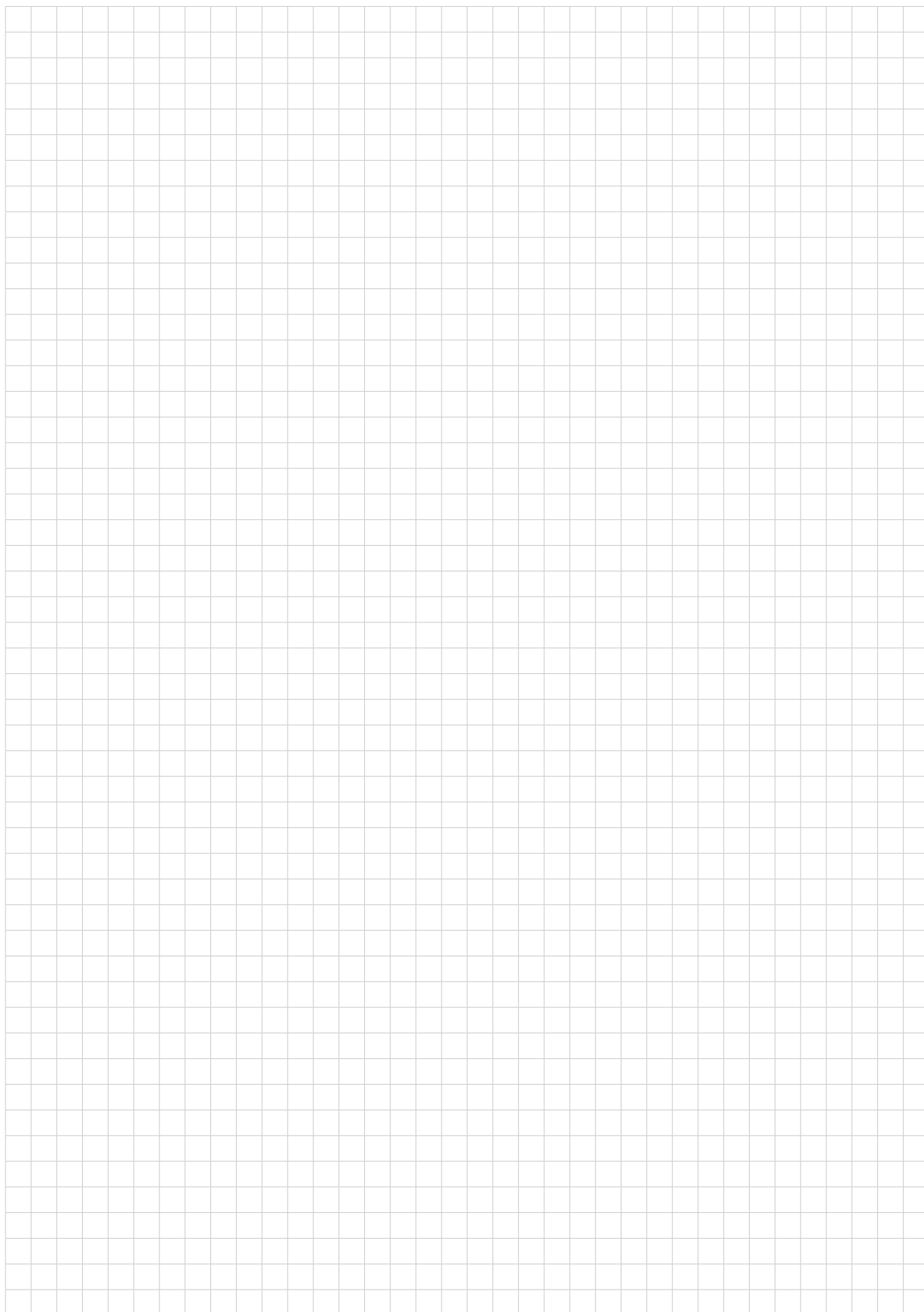



DISCOVER OUR ENTIRE PRODUCT RANGE

Our product range is divided into two catalogues: **Modern shower areas, profiles and systems** and **surface heating and cooling systems**. Both catalogues can be viewed on our website [blanke-blue-base.com](https://www.blanke-blue-base.com).



BLANKE'S DIGITAL WORLD

BLANKE BLUE BASE

The BLANKE BLUE BASE is a digital combination of product catalog, information material and a wish list for saving the selected products and systems with the option of forwarding. You can access the platform at blanke-blue-base.com.



BLANKE ON SOCIAL MEDIA

On our social media channel we post the latest news about Blanke, our projects and visions for the future. Follow us and discover input about our company, new products, carrier opportunities and events - or just gather inspiration from the pictures of our projects.



www.instagram.com/blanke_systems_global/



Consultation and sales:

Blanke Systems GmbH & Co. KG
Stenglingser Weg 68 - 70
58642 Iserlohn/Germany
T +49 (0)2374 507-0
E info@blanke-systems.de
I www.blanke-systems.com
I www.blanke-blue-base.com

FACHVERBAND
FLIESEN
UND NATURSTEIN

Im Zentralverband des Deutschen Baugewerbes



OH-DRUKFH25